

Date

4/28/2022



## Private Residential Villa

Ajman, UAE

## Content

Cover page .....	1
Content .....	2
Images .....	5

## Product data sheets

Linea Light Group - Epitax Downlight 6W DC (1x LED-XHP007-BC) .....	12
Linea Light Group - Epitax Downlight 10W (1x LED-XHP006-BC) .....	13
Linea Light Group - PU_C Plus - LED strip, IP66 - Led 12.6 W (1x 007000040U25) .....	14
Linea Light Group - Ribbon Plus - LED strip, IP20 - 12.6 W (1x 007000040U30) .....	15

Site 1 - Building 1 - Story 1

### 4. Bedroom 01

Summary / Light scene 1 .....	16
Calculation objects / Light scene 1 .....	18
4. Bedroom 01 Calculation Surface / Light scene 1 / Perpendicular illuminance .....	20

Site 1 - Building 1 - Story 1

### 8. Storage

Summary / Light scene 1 .....	21
Calculation objects / Light scene 1 .....	23
Working plane (8. Storage) / Light scene 1 / Perpendicular illuminance (adaptive) .....	25

Site 1 - Building 1 - Story 1

### 10. Junior Suite

Summary / Light scene 1 .....	26
Calculation objects / Light scene 1 .....	28
10. Junior Suite Calculation Surface / Light scene 1 / Perpendicular illuminance .....	30
10. Junior Suite Bed room Calculation Surface / Light scene 1 / Perpendicular illuminance .....	31

Site 1 - Building 1 - Story 1

### 12. Preparation

Summary / Light scene 1 .....	32
Calculation objects / Light scene 1 .....	34

## Content

Working plane (12. Preparation) / Light scene 1 / Perpendicular illuminance (adaptive)	36
--	----

Site 1 - Building 1 - Story 1

### 16.Majlis, 15. Guest Lobby, 17. Corridor, 13.Formal Dining, 14. Guest Toilet

Summary / Light scene 1	37
Calculation objects / Light scene 1	39
16. Majlis Calculation Surface / Light scene 1 / Perpendicular illuminance	41
15. Guest Lobby Calculation Surface / Light scene 1 / Perpendicular illuminance	42
17. Corridor Calculation Surface / Light scene 1 / Perpendicular illuminance	43
14. Guest Toilet Calculation Surface Counter / Light scene 1 / Perpendicular illuminance	44
14. Guest Toilet Calculation Surface / Light scene 1 / Perpendicular illuminance	45
13. Formal Dining Calculation Surface / Light scene 1 / Perpendicular illuminance	46

Site 1 - Building 1 - Story 1

### 22. Toilet

Summary / Light scene 1	47
Calculation objects / Light scene 1	49
Working plane (22. Toilet) / Light scene 1 / Perpendicular illuminance (adaptive)	51
22. Toilet Counter Calculation Surface / Light scene 1 / Perpendicular illuminance	52

Site 1 - Building 1 - Story 1

### Art Area, 7. OPen Kitchen, Family Dining, 5. P Lay Room, 9. Corridor

Summary / Light scene 1	53
Calculation objects / Light scene 1	55
7. Open Kitchen Counter Calculation Surface / Light scene 1 / Perpendicular illuminance	57
09. Corridor Calculation Surface / Light scene 1 / Perpendicular illuminance	58
6. Family toilet Calculation surface / Light scene 1 / Perpendicular illuminance	59

Site 1 - Building 1 - Story 1

### Family Toilet 1

Summary / Light scene 1	60
Calculation objects / Light scene 1	62

## Content

Working plane (Family Toilet 1) / Light scene 1 / Perpendicular illuminance (adaptive) .....	64
--	----

Site 1 - Building 1 - Story 1

### Family Toilet 2

Summary / Light scene 1 .....	65
Calculation objects / Light scene 1 .....	67
Working plane (Family Toilet 2) / Light scene 1 / Perpendicular illuminance (adaptive) .....	69

Site 1 - Building 1 - Story 1

### Guest Toilet 1

Summary / Light scene 1 .....	70
Calculation objects / Light scene 1 .....	72
Working plane (Guest Toilet 1) / Light scene 1 / Perpendicular illuminance (adaptive) .....	74
Calculation surface 7 / Light scene 1 / Perpendicular illuminance .....	75



# Majlis

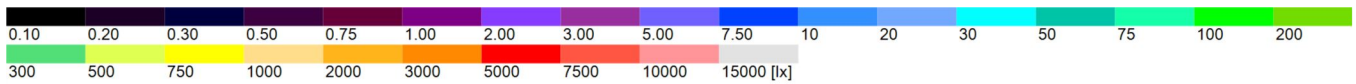
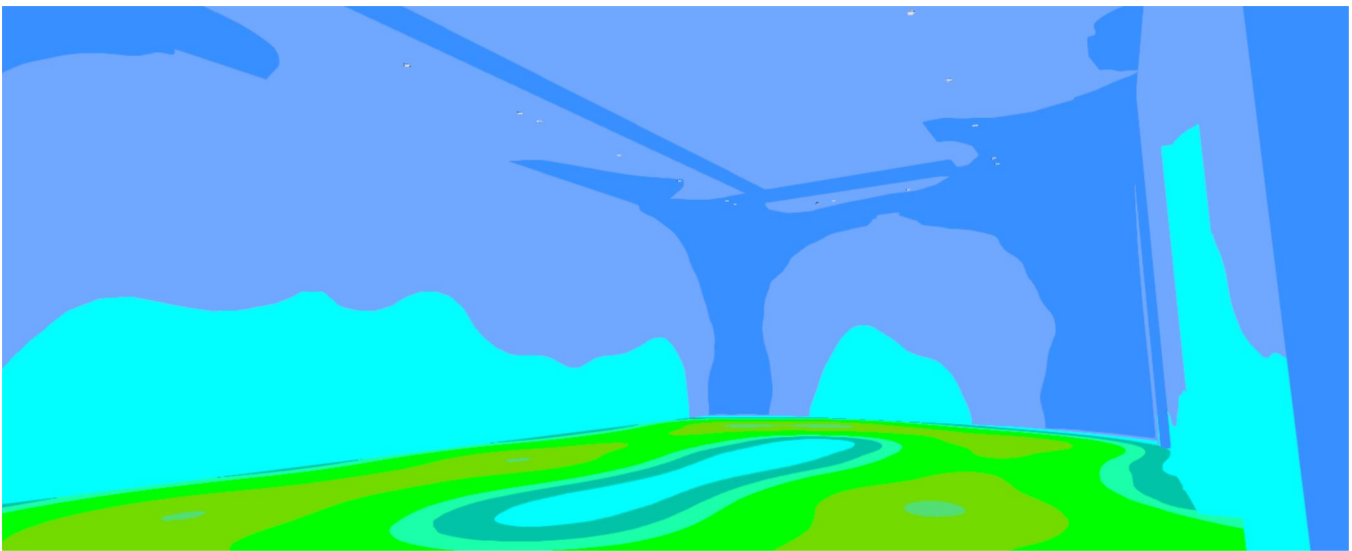

## Guest Lobby

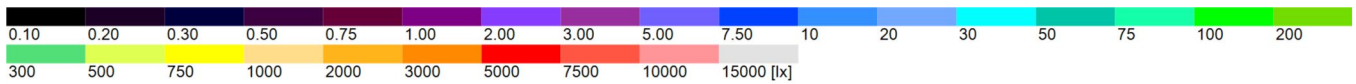
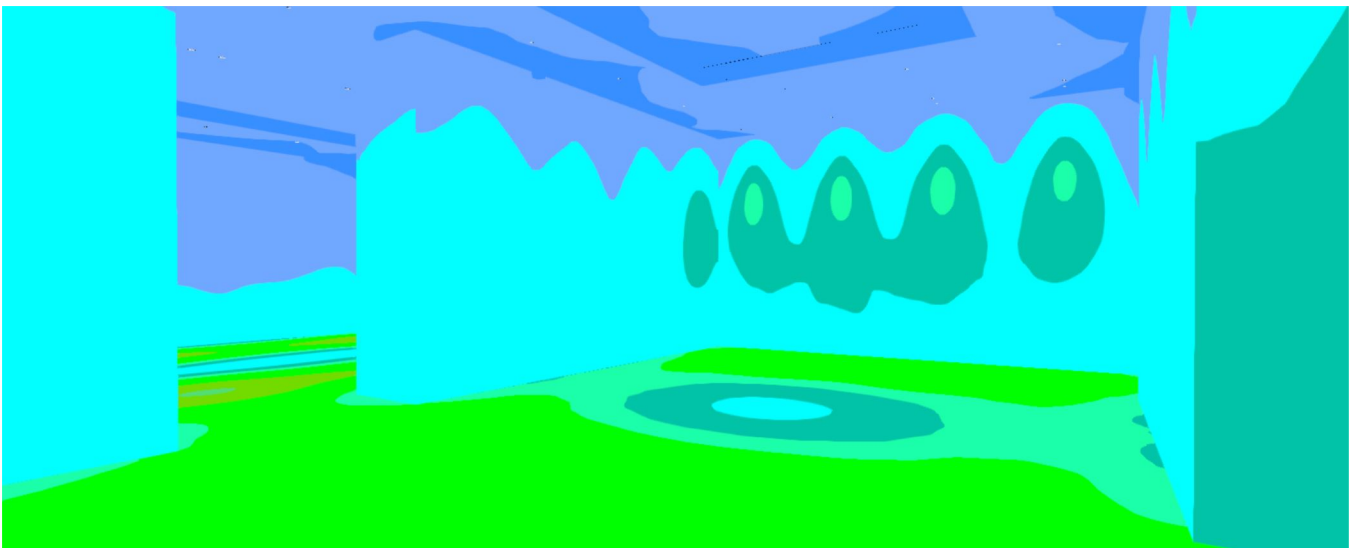

## Formal Dining

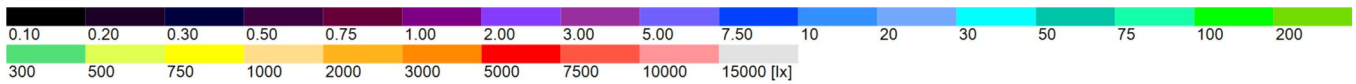
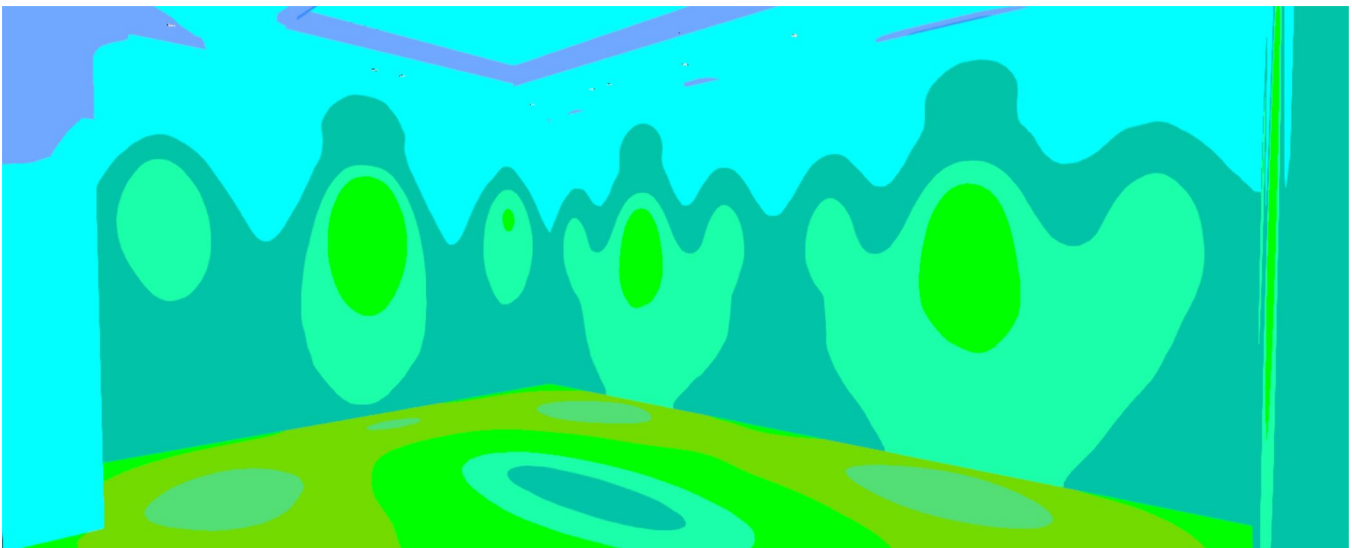
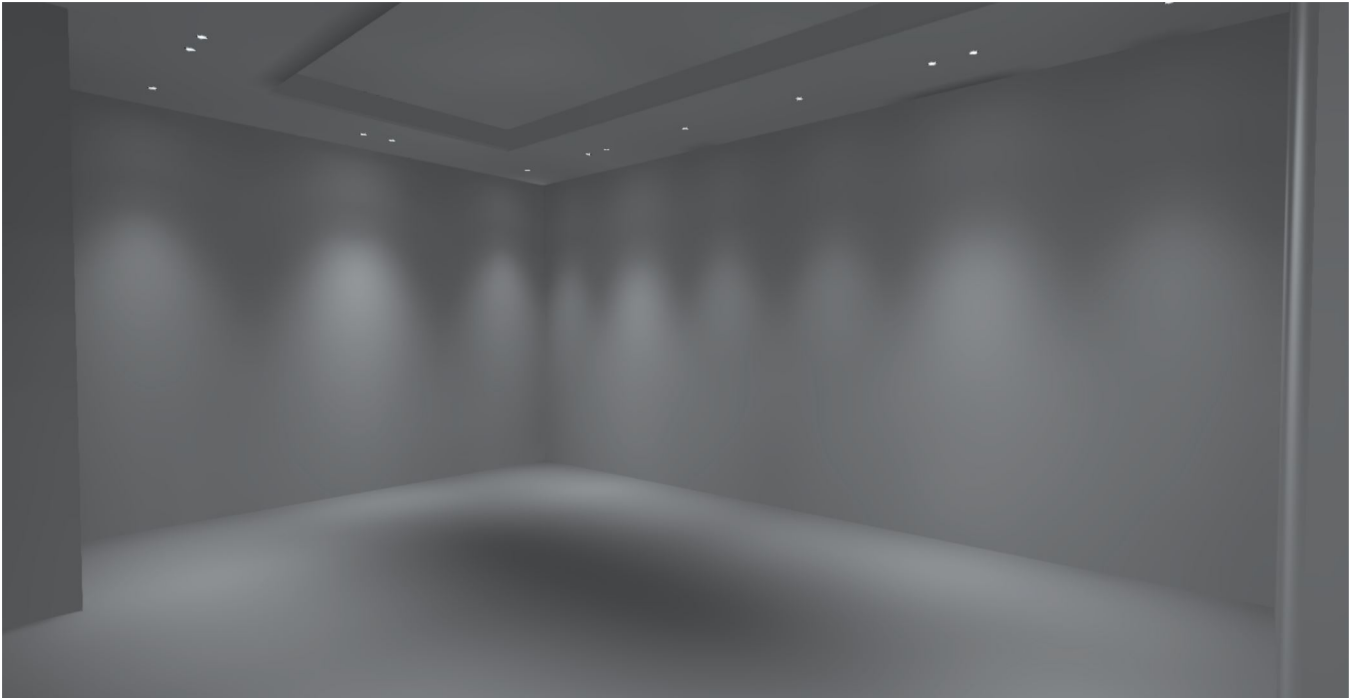

## Junior Suite

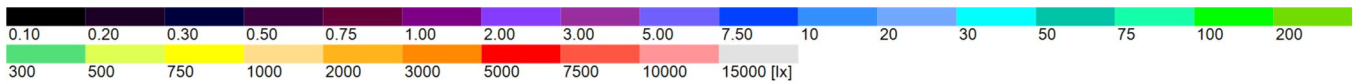
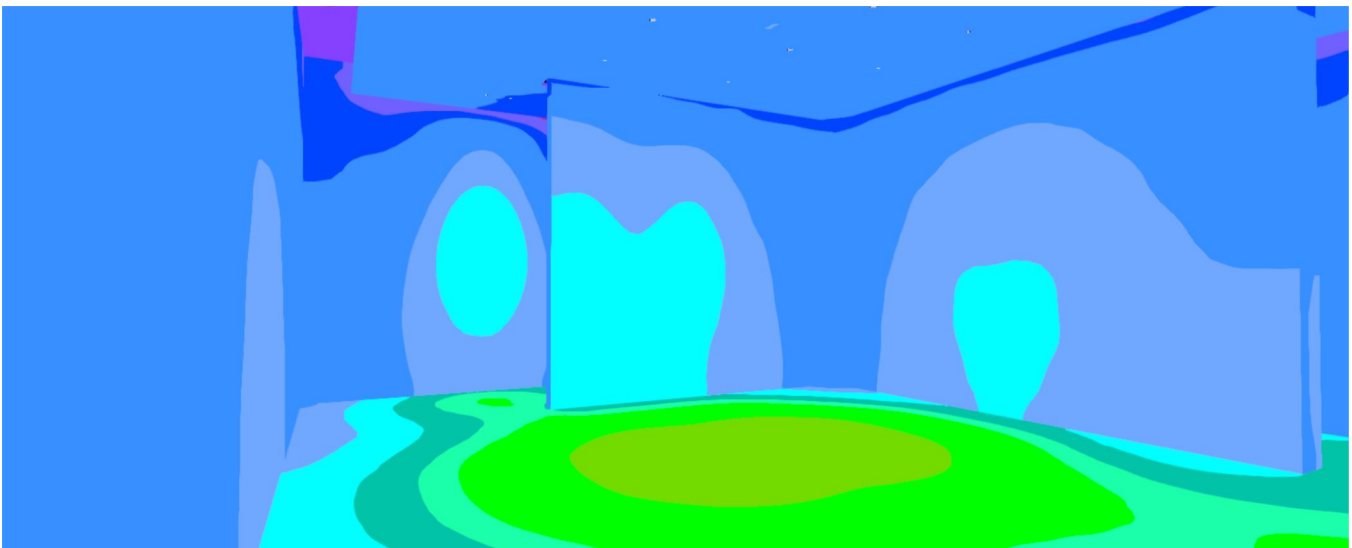
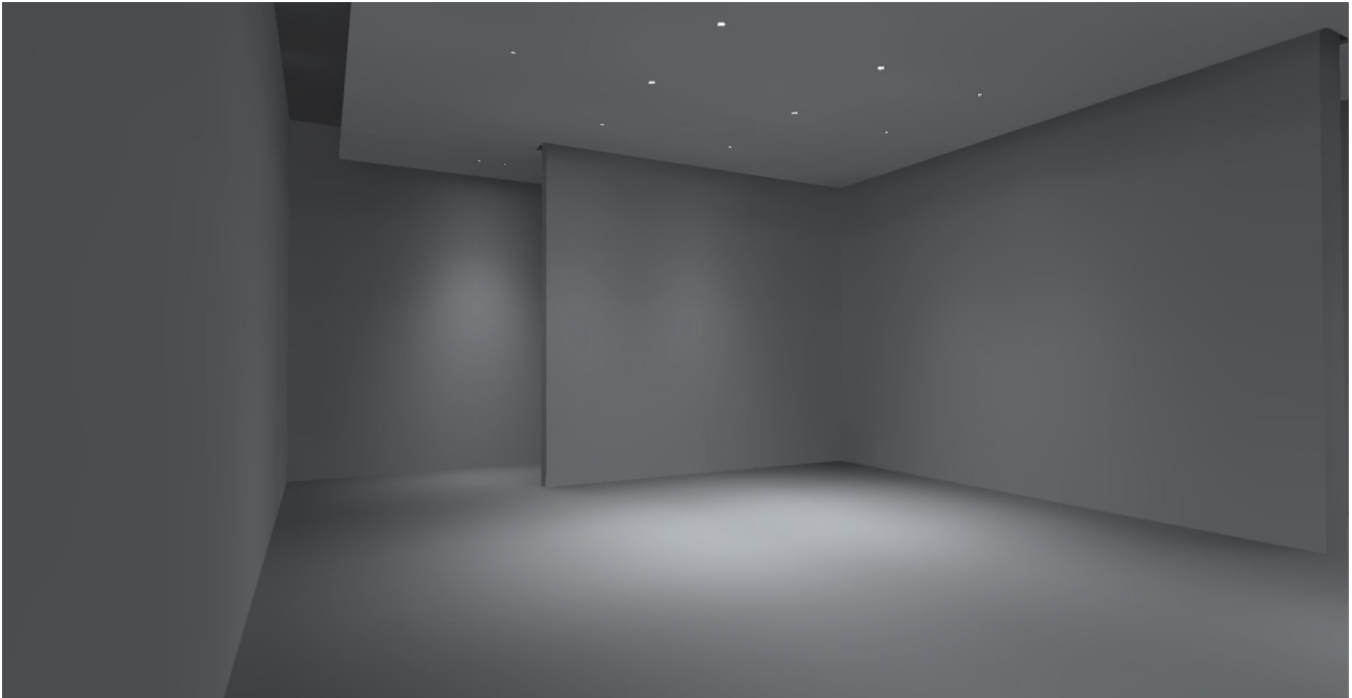

# Corridor

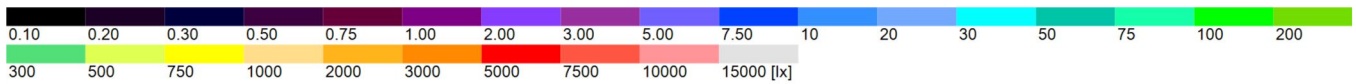
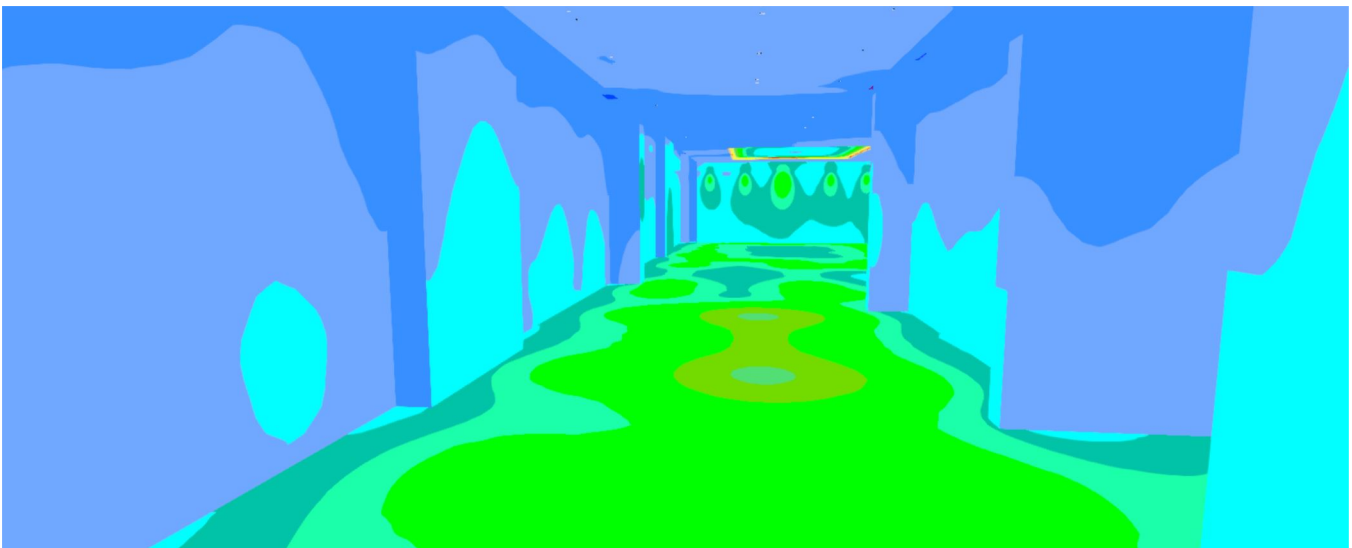

# Play Room

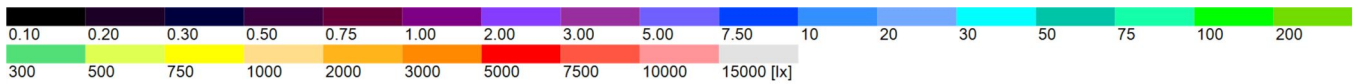
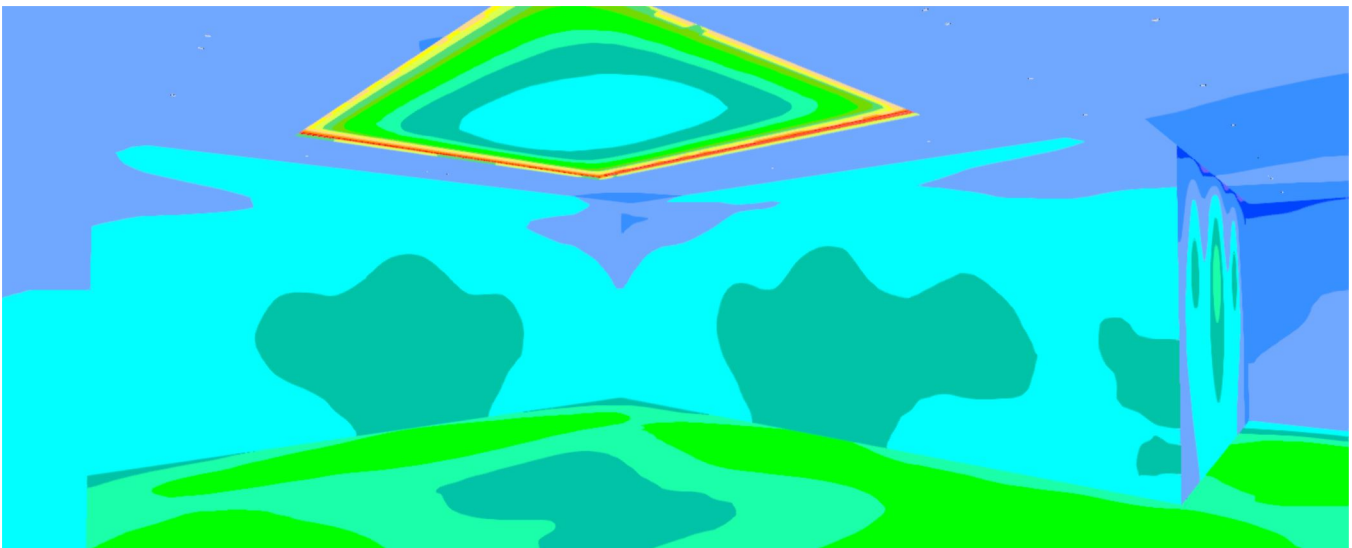
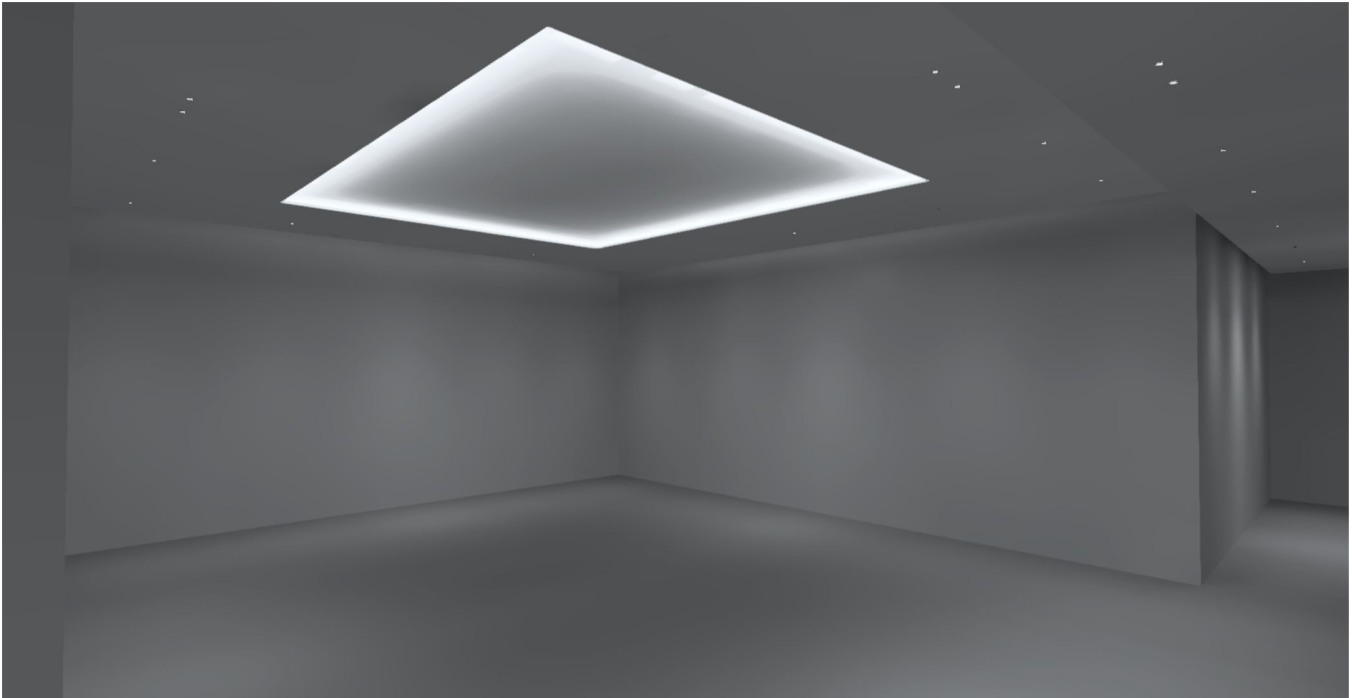

## Family Living

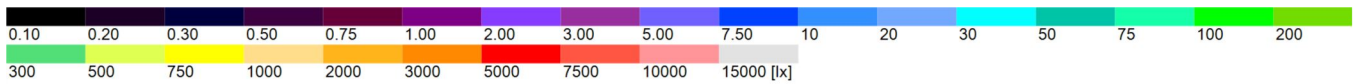
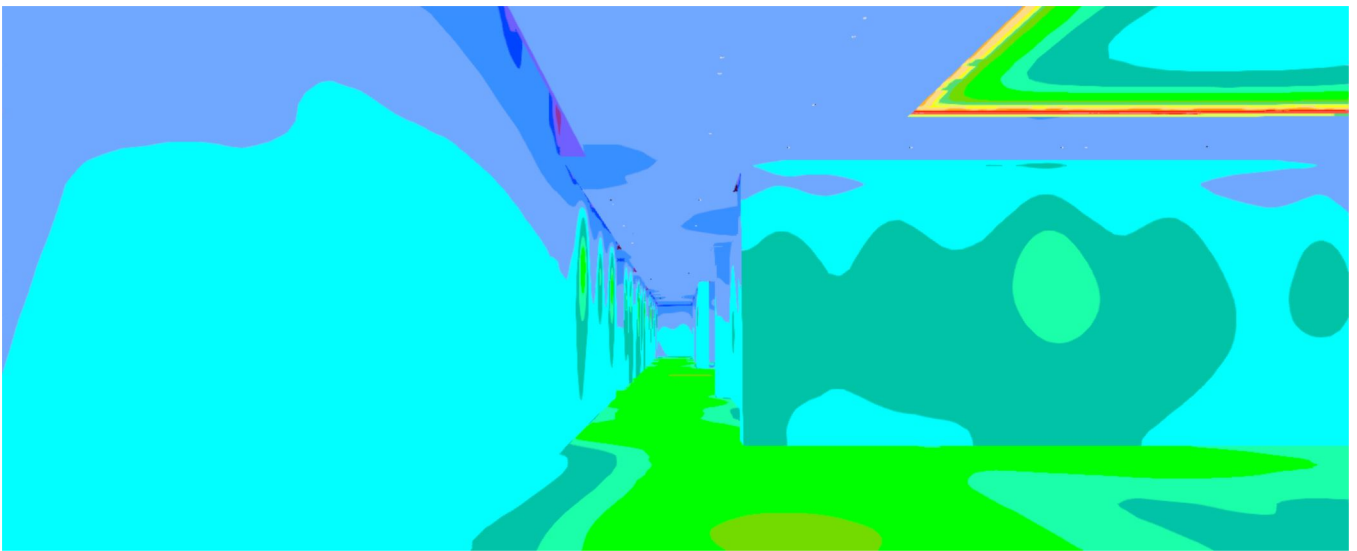



## Product data sheet

Linea Light Group - Epitax Downlight 6W DC



Article No.	80640W30
P	6.0 W
$\Phi_{Lamp}$	351 lm
$\Phi_{Luminaire}$	351 lm
$\eta$	100.00 %
Luminous efficacy	58.5 lm/W
CCT	3000 K
CRI	92

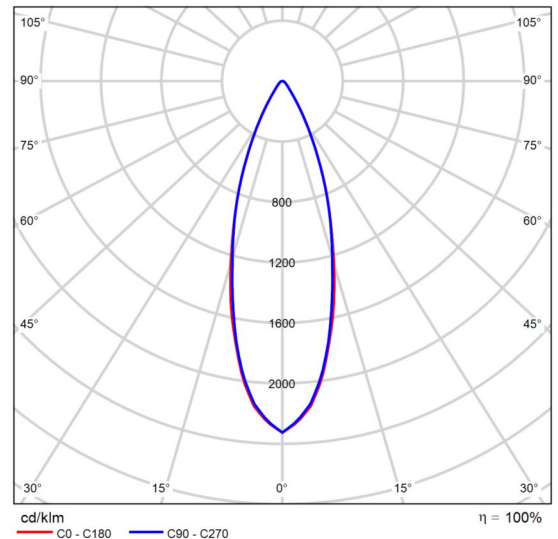

Polar LDC

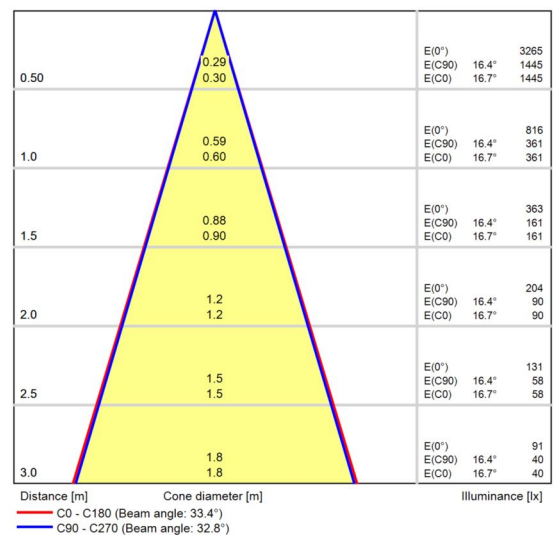

Cone diagram



## Product data sheet

Linea Light Group - Epitax Downlight 10W



Article No.	80595W30
P	10.0 W
$\Phi_{Lamp}$	681 lm
$\Phi_{Luminaire}$	681 lm
$\eta$	100.00 %
Luminous efficacy	68.1 lm/W
CCT	3000 K
CRI	92

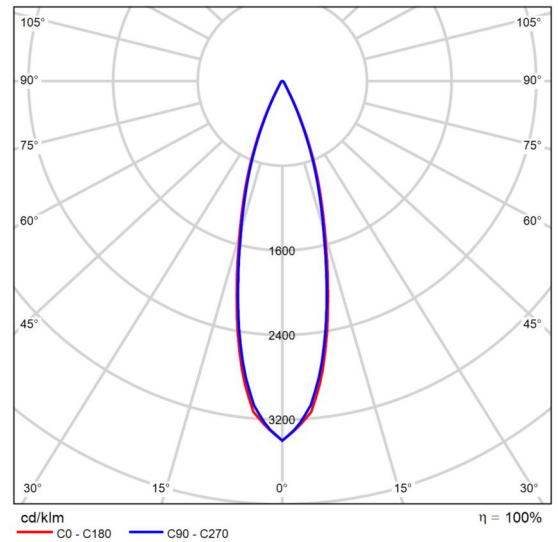

Polar LDC

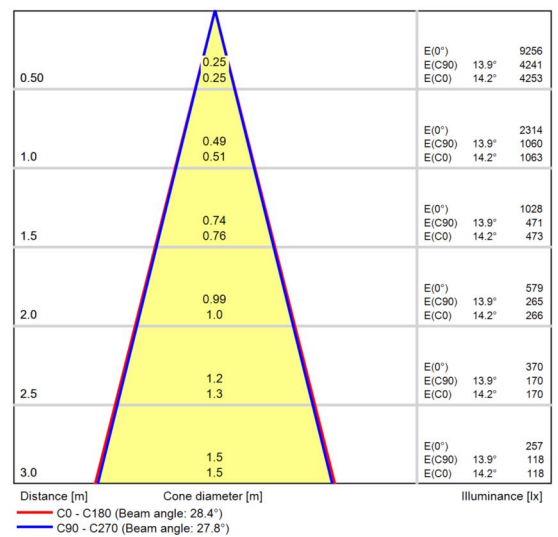

Cone diagram



# Product data sheet

Linea Light Group - PU\_C Plus - LED strip, IP66 - Led 12.6 W



Article No.	98779
P	12.6 W
$\Phi_{Lamp}$	1299 lm
$\Phi_{Luminaire}$	1298 lm
$\eta$	99.92 %
Luminous efficacy	103.0 lm/W
CCT	3000 K
CRI	85

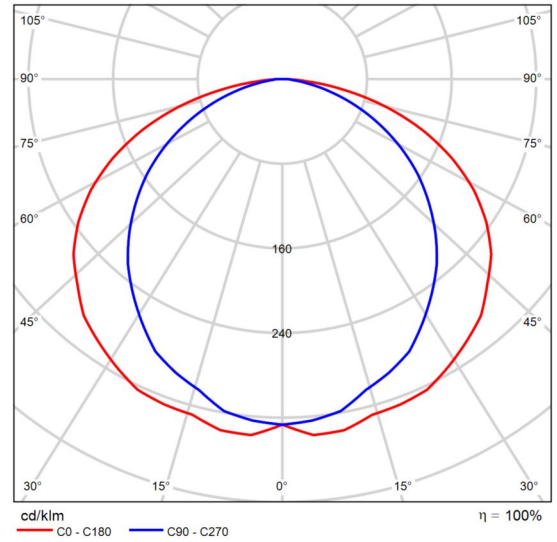

Polar LDC

Glare evaluation according to UGR												
p Ceiling		70	70	50	50	30	70	70	50	50	30	
p Walls		50	30	50	30	30	50	30	50	30	30	
p Floor		20	20	20	20	20	20	20	20	20	20	
Room size	X	Viewing direction at right angles to lamp axis					Viewing direction parallel to lamp axis					
	Y											
2H	2H	26.1	27.5	26.4	27.8	28.0	24.1	25.5	24.4	25.8	26.0	
	3H	28.1	29.3	28.4	29.6	29.9	25.4	26.7	25.8	27.0	27.2	
	4H	28.9	30.1	29.2	30.3	30.6	25.9	27.1	26.3	27.4	27.7	
	6H	29.4	30.5	29.8	30.8	31.2	26.2	27.3	26.5	27.6	27.9	
	8H	29.6	30.7	30.0	31.0	31.3	26.2	27.3	26.6	27.6	27.9	
	12H	29.7	30.7	30.1	31.0	31.4	26.3	27.3	26.6	27.6	28.0	
4H	2H	26.6	27.8	27.0	28.1	28.4	25.0	26.2	25.4	26.5	26.8	
	3H	28.7	29.7	29.1	30.0	30.4	26.5	27.5	26.9	27.9	28.2	
	4H	29.6	30.5	30.0	30.9	31.3	27.1	28.0	27.5	28.3	28.7	
	6H	30.3	31.1	30.7	31.5	31.9	27.4	28.2	27.8	28.6	29.0	
	8H	30.5	31.3	31.0	31.7	32.1	27.5	28.3	28.0	28.7	29.1	
	12H	30.7	31.3	31.1	31.8	32.2	27.6	28.2	28.0	28.7	29.1	
8H	4H	29.8	30.5	30.2	30.9	31.3	27.5	28.2	27.9	28.6	29.0	
	6H	30.5	31.2	31.0	31.6	32.0	27.9	28.5	28.4	29.0	29.4	
	8H	30.8	31.4	31.3	31.8	32.3	28.1	28.6	28.6	29.1	29.6	
	12H	31.0	31.5	31.5	32.0	32.5	28.2	28.6	28.7	29.1	29.6	
12H	4H	29.7	30.4	30.2	30.8	31.3	27.5	28.2	28.0	28.6	29.0	
	6H	30.6	31.1	31.0	31.5	32.0	28.0	28.6	28.5	29.0	29.5	
	8H	30.9	31.3	31.4	31.8	32.3	28.2	28.7	28.7	29.1	29.6	
Variation of the observer position for the luminaire distances S												
S = 1.0H		+0.1 / -0.1					+0.1 / -0.1					
S = 1.5H		+0.2 / -0.2					+0.3 / -0.5					
S = 2.0H		+0.4 / -0.4					+0.5 / -0.9					
Standard table		BK06					BK05					
Correction Summand		13.7					10.7					
Corrected glare indices referring to 1299lm Total luminous flux												

UGR diagram (SHR: 0.25)



## Product data sheet

Linea Light Group - Ribbon Plus - LED strip, IP20 - 12.6 W



Article No.	98639
P	12.6 W
$\Phi_{Lamp}$	1595 lm
$\Phi_{Luminaire}$	1594 lm
$\eta$	99.91 %
Luminous efficacy	126.5 lm/W
CCT	3000 K
CRI	85

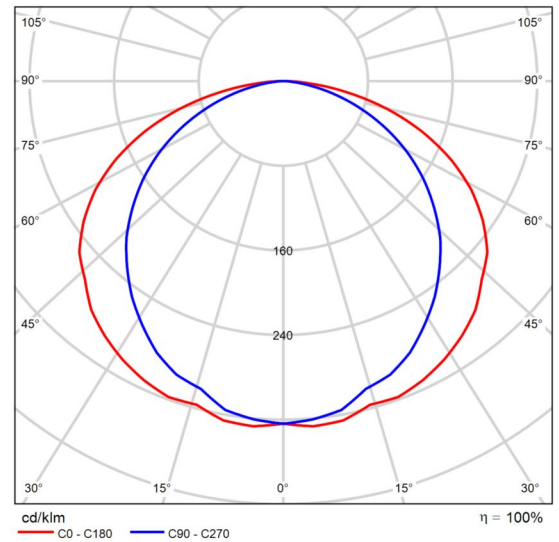

Polar LDC

Glare evaluation according to UGR														
	70		50		30		70		50		30			
p Ceiling	50	30	50	30	50	30	50	30	50	30	50	30		
p Walls	20	20	20	20	20	20	20	20	20	20	20	20		
p Floor	Viewing direction at right angles to lamp axis						Viewing direction parallel to lamp axis							
Room size	X	Y												
2H	2H	28.2	29.6	28.5	29.8	30.1	26.4	27.8	26.7	28.1	28.3	28.3		
	3H	30.2	31.4	30.5	31.7	32.0	27.8	29.1	28.2	29.4	29.7	29.7		
	4H	31.0	32.2	31.3	32.5	32.8	28.3	29.5	28.7	29.8	30.1	30.1		
	6H	31.6	32.7	31.9	33.0	33.3	28.6	29.8	29.0	30.1	30.4	30.4		
	8H	31.8	32.9	32.1	33.2	33.5	28.7	29.8	29.1	30.1	30.4	30.4		
12H	31.9	32.9	32.3	33.2	33.6	28.7	29.8	29.1	30.1	30.4	30.4	30.4		
4H	2H	28.7	29.9	29.0	30.2	30.5	27.3	28.5	27.7	28.8	29.1	29.1		
	3H	30.8	31.9	31.2	32.2	32.5	28.9	29.9	29.3	30.2	30.6	30.6		
	4H	31.8	32.7	32.2	33.1	33.4	29.5	30.4	29.9	30.8	31.1	31.1		
	6H	32.5	33.3	33.0	33.7	34.1	29.9	30.7	30.3	31.1	31.5	31.5		
	8H	32.8	33.5	33.2	33.9	34.3	30.0	30.7	30.4	31.1	31.5	31.5		
12H	32.9	33.6	33.4	34.0	34.5	30.0	30.7	30.5	31.1	31.6	31.6			
8H	4H	32.0	32.7	32.4	33.1	33.5	29.9	30.7	30.3	31.1	31.5	31.5		
	6H	32.8	33.4	33.3	33.9	34.3	30.4	31.0	30.9	31.4	31.9	31.9		
	8H	33.1	33.7	33.6	34.1	34.6	30.6	31.1	31.0	31.5	32.0	32.0		
	12H	33.4	33.8	33.9	34.3	34.8	30.6	31.1	31.1	31.6	32.1	32.1		
	12H	4H	31.9	32.6	32.4	33.0	33.5	30.0	30.6	30.4	31.1	31.5	31.5	
6H	32.8	33.4	33.3	33.8	34.3	30.5	31.0	31.0	31.5	32.0	32.0			
8H	33.2	33.7	33.7	34.1	34.6	30.7	31.1	31.2	31.6	32.1	32.1			
Variation of the observer position for the luminaire distances S														
S = 1.0H	+0.1 / -0.1						+0.1 / -0.1							
S = 1.5H	+0.2 / -0.2						+0.3 / -0.4							
S = 2.0H	+0.4 / -0.3						+0.5 / -0.8							
Standard table	BK07						BK05							
Correction Summand	16.4						13.1							
Corrected glare indices referring to 1595lm Total luminous flux														

UGR diagram (SHR: 0.25)

Building 1 · Story 1 · 4. Bedroom 01 (Light scene 1)

Summary

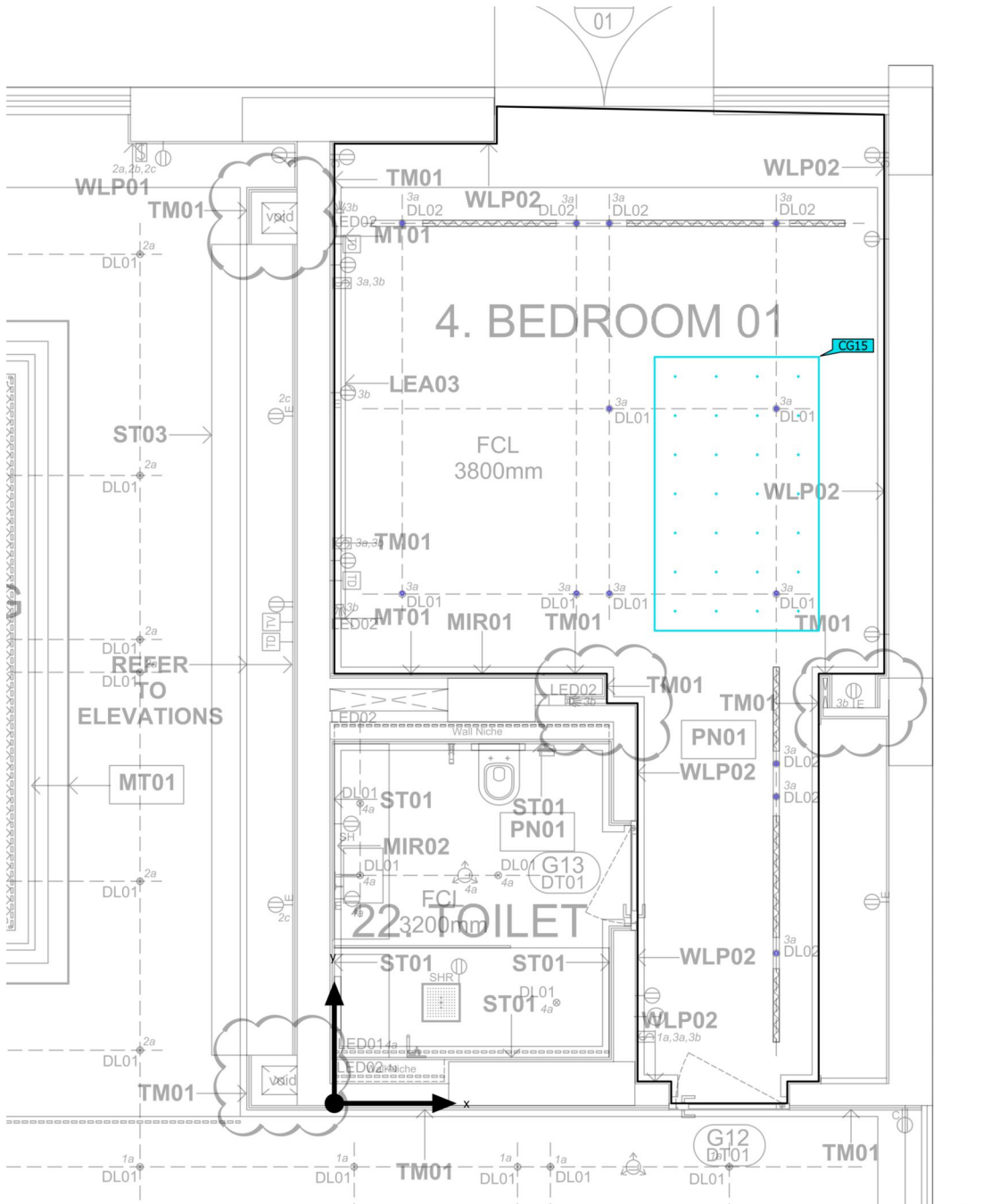



Building 1 · Story 1 · 4. Bedroom 01 (Light scene 1)

## Summary

### Results

Utilization profile: DIALux presetting, Standard (office)

### Luminaire list

pcs.	Manufacturer	Article No.	Article name	P	Φ	Luminous efficacy
13	Linea Light Group	80640W30	Epitax Downlight 6W DC	6.0 W	351 lm	58.5 lm/W

Building 1 · Story 1 · 4. Bedroom 01 (Light scene 1)

Calculation objects

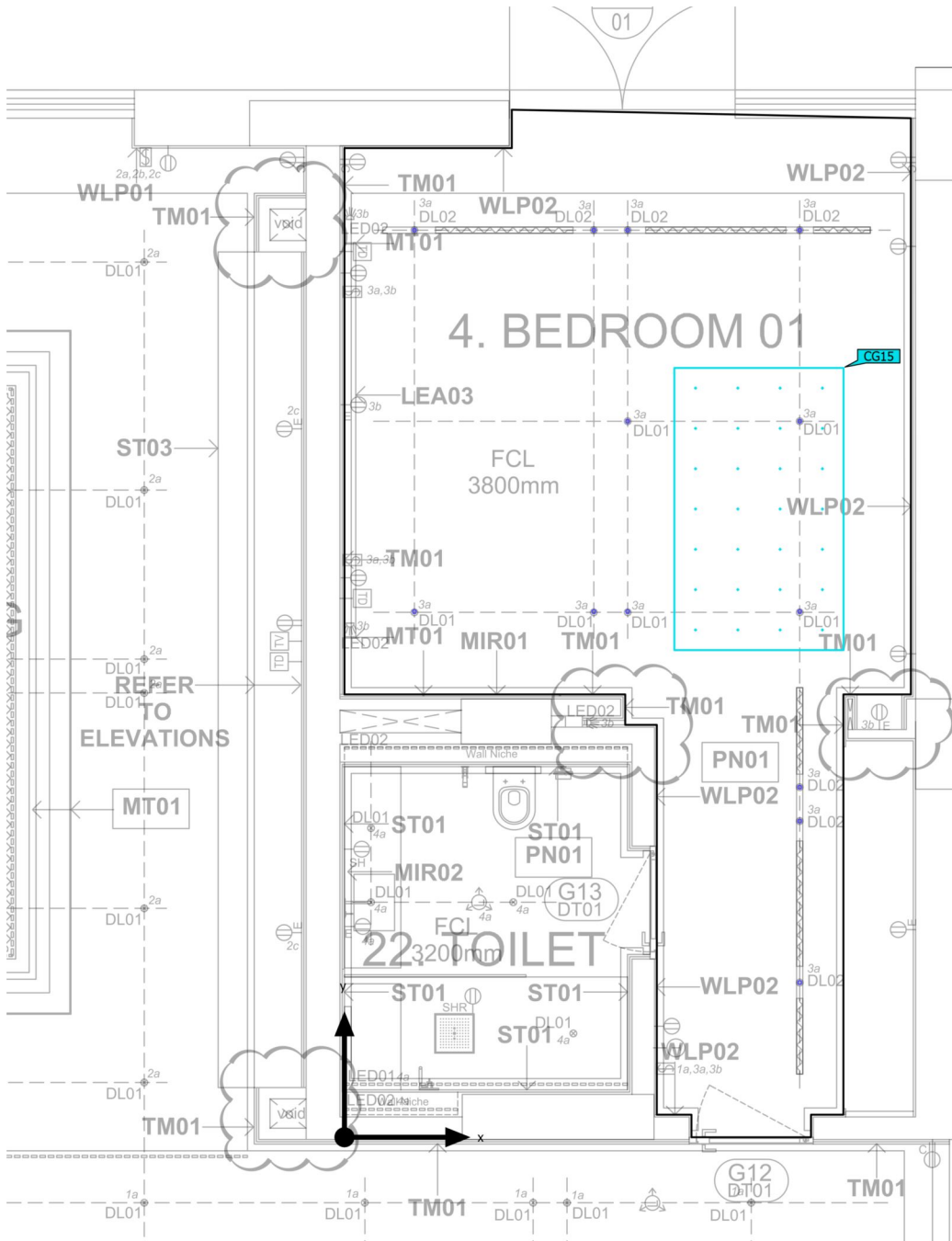

Building 1 · Story 1 · 4. Bedroom 01 (Light scene 1)

## Calculation objects

### Calculation surfaces

Properties	$\bar{E}$	$E_{min}$	$E_{max}$	$g_1$	$g_2$	Index
4. Bedroom 01 Calculation Surface Perpendicular illuminance Height: 0.000 m	108 lx	88.8 lx	128 lx	0.82	0.69	CG15

Utilization profile: DIALux presetting, Standard (office)

Building 1 · Story 1 · 4. Bedroom 01 (Light scene 1)

### 4. Bedroom 01 Calculation Surface

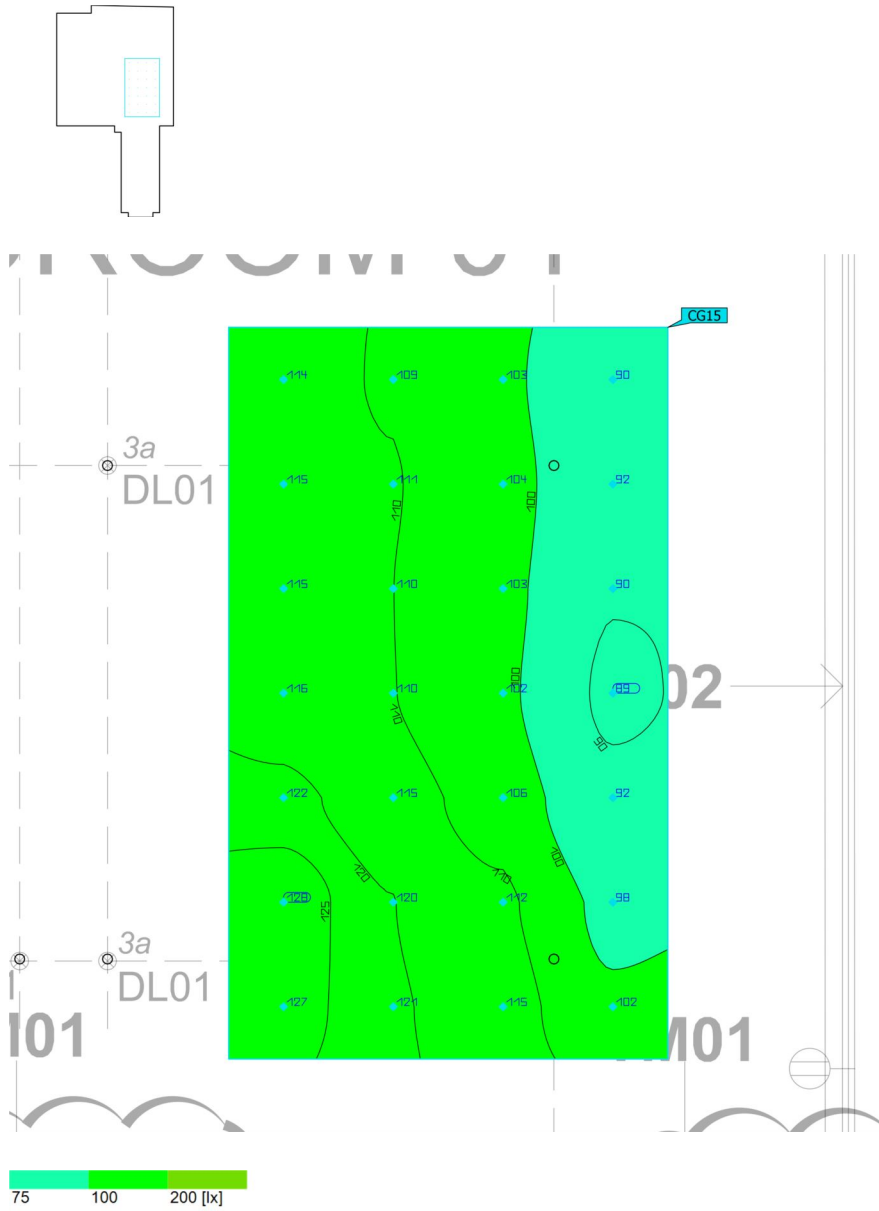

Properties	$\bar{E}$	$E_{min}$	$E_{max}$	$g_1$	$g_2$	Index
4. Bedroom 01 Calculation Surface Perpendicular illuminance Height: 0.000 m	108 lx	88.8 lx	128 lx	0.82	0.69	CG15

Utilization profile: DIALux presetting, Standard (office)



Building 1 · Story 1 · 8. Storage (Light scene 1)

### Summary

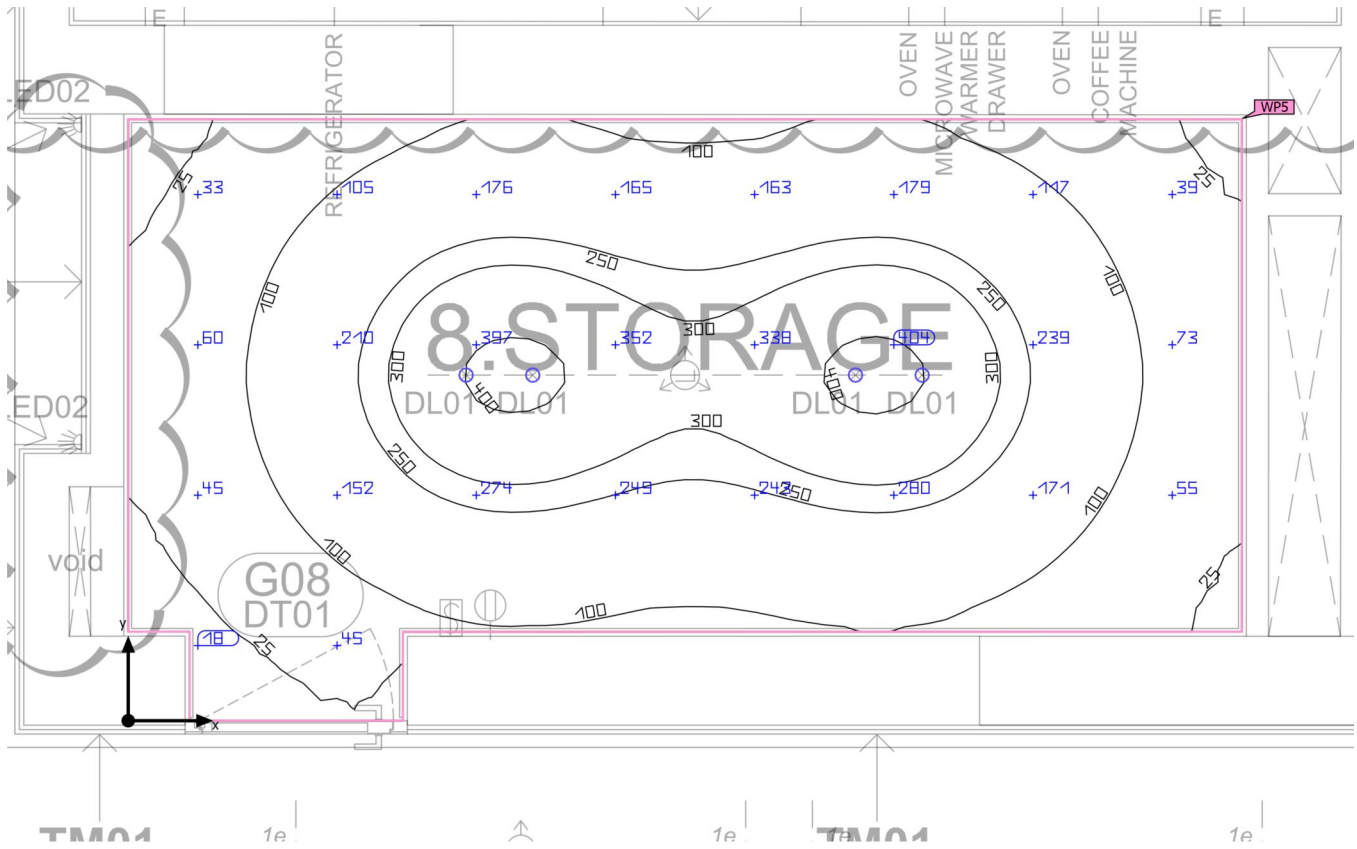

Building 1 · Story 1 · 8. Storage (Light scene 1)

## Summary

### Results

	Symbol	Calculated	Index
Working plane	$\bar{E}_{\text{perpendicular}}$	169 lx	WP5
	$g_1$	0.070	WP5

Utilization profile: DIALux presetting, Standard (office)

### Luminaire list

pcs.	Manufacturer	Article No.	Article name	P	$\Phi$	Luminous efficacy
4	Linea Light Group	80595W30	Epitax Downlight 10W	10.0 W	681 lm	68.1 lm/W

Building 1 · Story 1 · 8. Storage (Light scene 1)

### Calculation objects

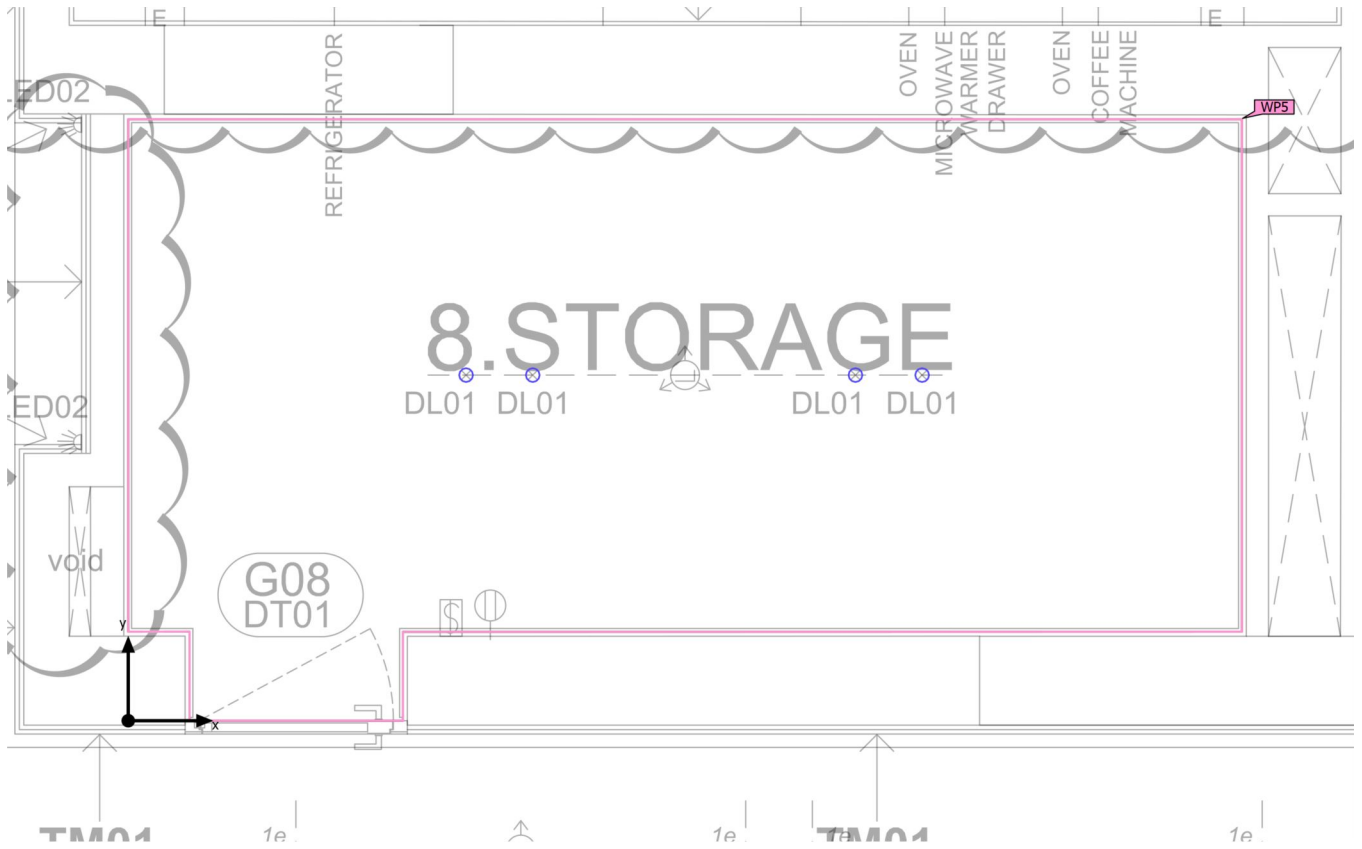

Building 1 · Story 1 · 8. Storage (Light scene 1)

## Calculation objects

### Working planes

Properties	$\bar{E}$	$E_{\min}$	$E_{\max}$	$g_1$	$g_2$	Index
Working plane (8. Storage) Perpendicular illuminance (adaptive) Height: 0.800 m, Wall zone: 0.000 m	169 lx	11.8 lx	417 lx	0.070	0.028	WP5

Utilization profile: DIALux presetting, Standard (office)

Building 1 · Story 1 · 8. Storage (Light scene 1)

### Working plane (8. Storage)

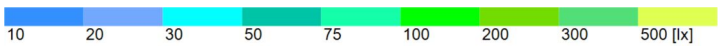
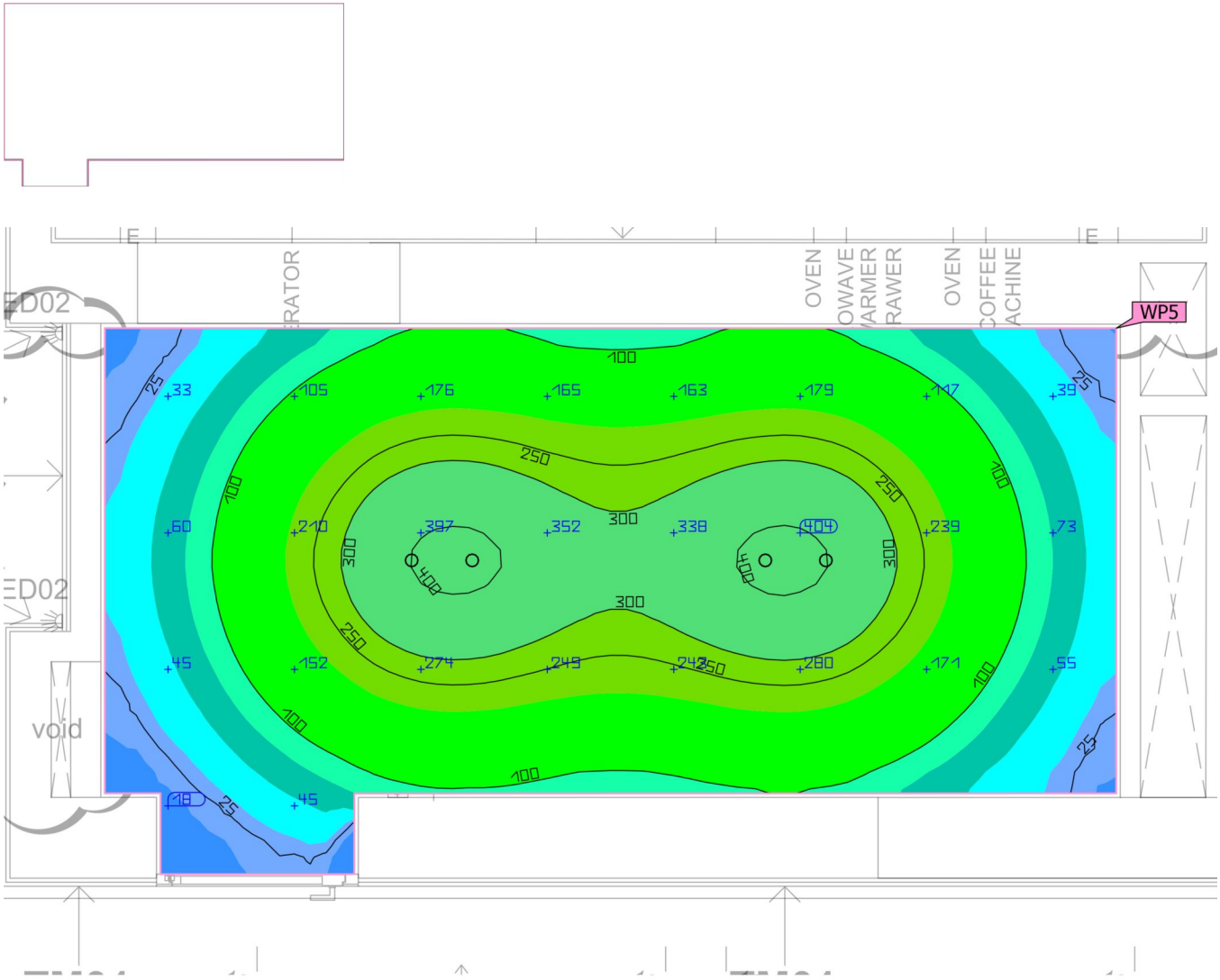

Properties	$\bar{E}$	$E_{min}$	$E_{max}$	$g_1$	$g_2$	Index
Working plane (8. Storage) Perpendicular illuminance (adaptive) Height: 0.800 m, Wall zone: 0.000 m	169 lx	11.8 lx	417 lx	0.070	0.028	WP5

Utilization profile: DIALux presetting, Standard (office)

# Building 1 · Story 1 · 10. Junior Suite (Light scene 1) Summary

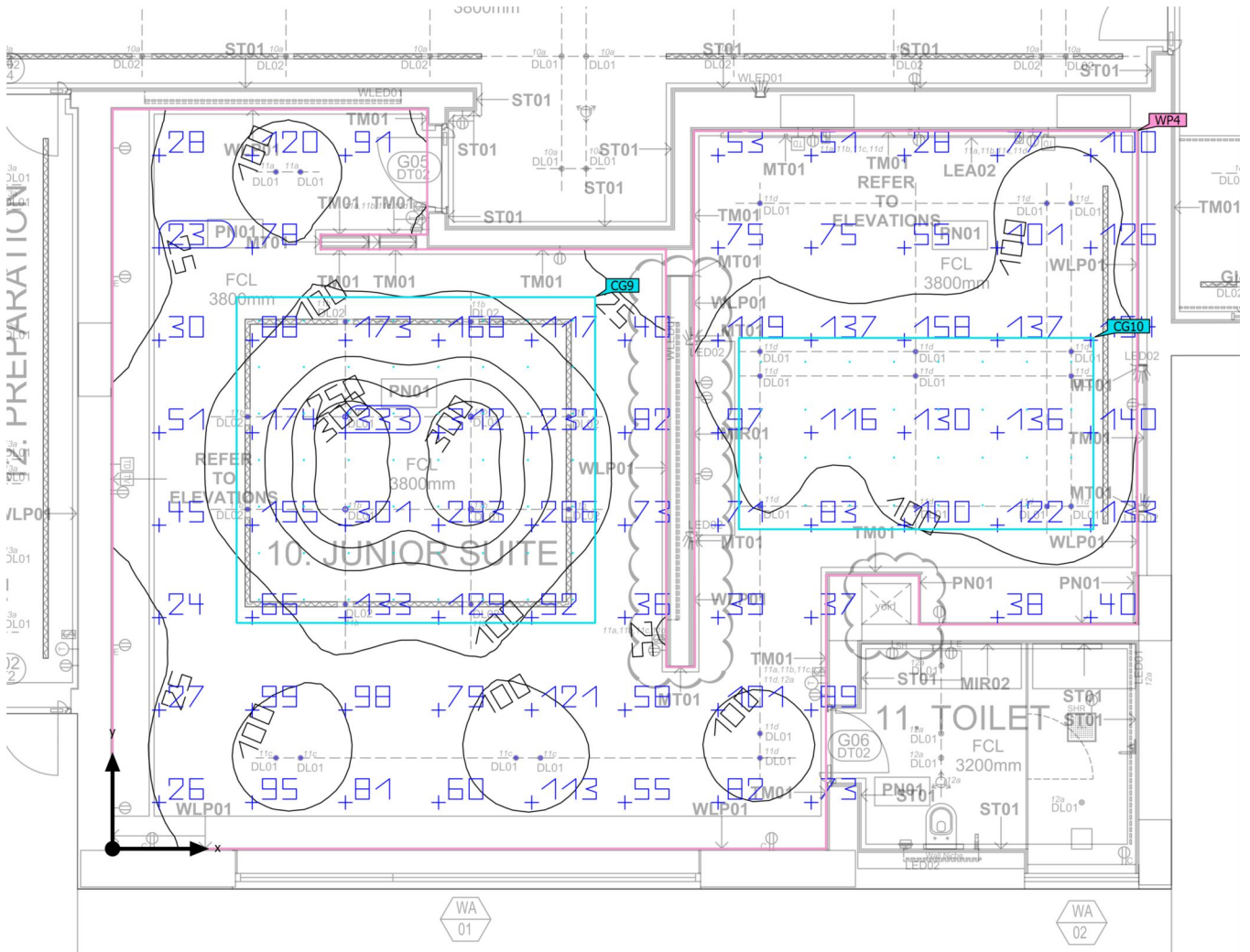

Building 1 · Story 1 · 10. Junior Suite (Light scene 1)

## Summary

### Results

	Symbol	Calculated	Index
Working plane	$\bar{E}_{\text{perpendicular}}$	104 lx	WP4
	$g_1$	0.097	WP4

Utilization profile: DIALux presetting, Standard (office)

### Luminaire list

pcs.	Manufacturer	Article No.	Article name	P	$\Phi$	Luminous efficacy
4	Linea Light Group	80595W30	Epitax Downlight 10W	10.0 W	681 lm	68.1 lm/W
29	Linea Light Group	80640W30	Epitax Downlight 6W DC	6.0 W	351 lm	58.5 lm/W

# Building 1 · Story 1 · 10. Junior Suite (Light scene 1) Calculation objects

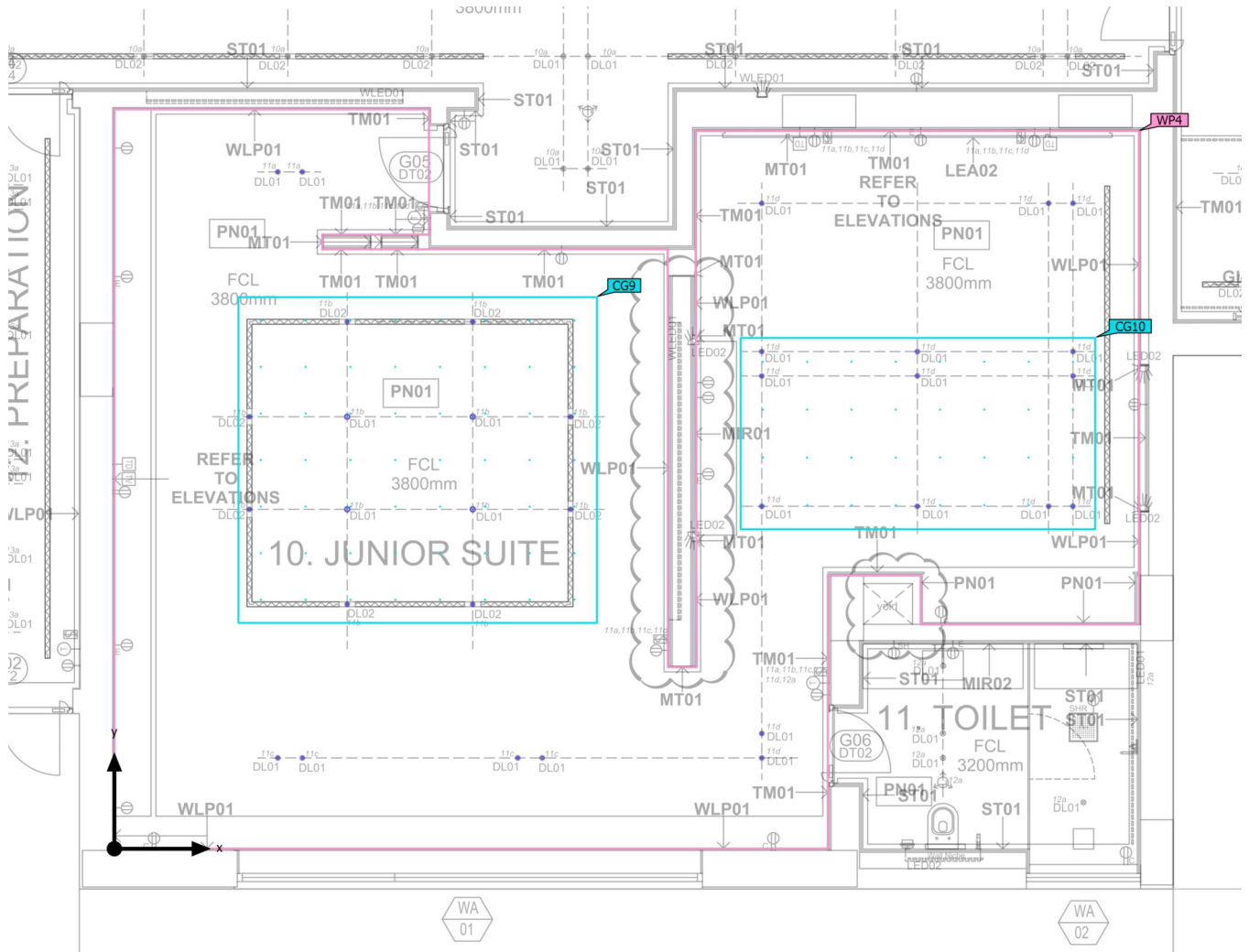



Building 1 · Story 1 · 10. Junior Suite (Light scene 1)

## Calculation objects

### Working planes

Properties	$\bar{E}$	$E_{min}$	$E_{max}$	$g_1$	$g_2$	Index
Working plane (10. Junior Suite) Perpendicular illuminance (adaptive) Height: 0.800 m, Wall zone: 0.000 m	104 lx	10.1 lx	333 lx	0.097	0.030	WP4

### Calculation surfaces

Properties	$\bar{E}$	$E_{min}$	$E_{max}$	$g_1$	$g_2$	Index
10. Junior Suite Calculation Surface Perpendicular illuminance Height: 0.000 m	186 lx	68.5 lx	298 lx	0.37	0.23	CG9
10. Junior Suite Bed room Calculation Surface Perpendicular illuminance Height: 0.000 m	125 lx	88.7 lx	145 lx	0.71	0.61	CG10

Utilization profile: DIALux presetting, Standard (office)

Building 1 · Story 1 · 10. Junior Suite (Light scene 1)

### 10. Junior Suite Calculation Surface

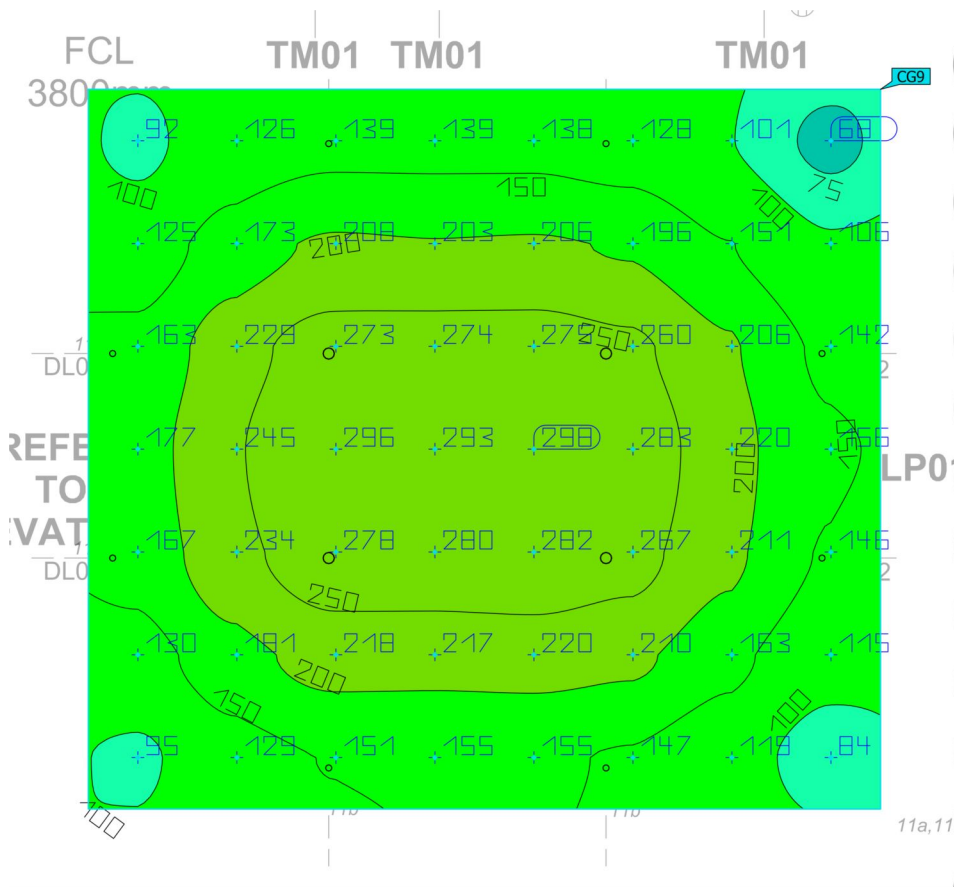
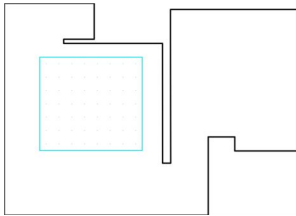

Properties	$\bar{E}$	$E_{min}$	$E_{max}$	$g_1$	$g_2$	Index
10. Junior Suite Calculation Surface Perpendicular illuminance Height: 0.000 m	186 lx	68.5 lx	298 lx	0.37	0.23	CG9

Utilization profile: DIALux presetting, Standard (office)

Building 1 · Story 1 · 10. Junior Suite (Light scene 1)

### 10. Junior Suite Bed room Calculation Surface

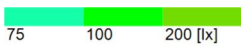
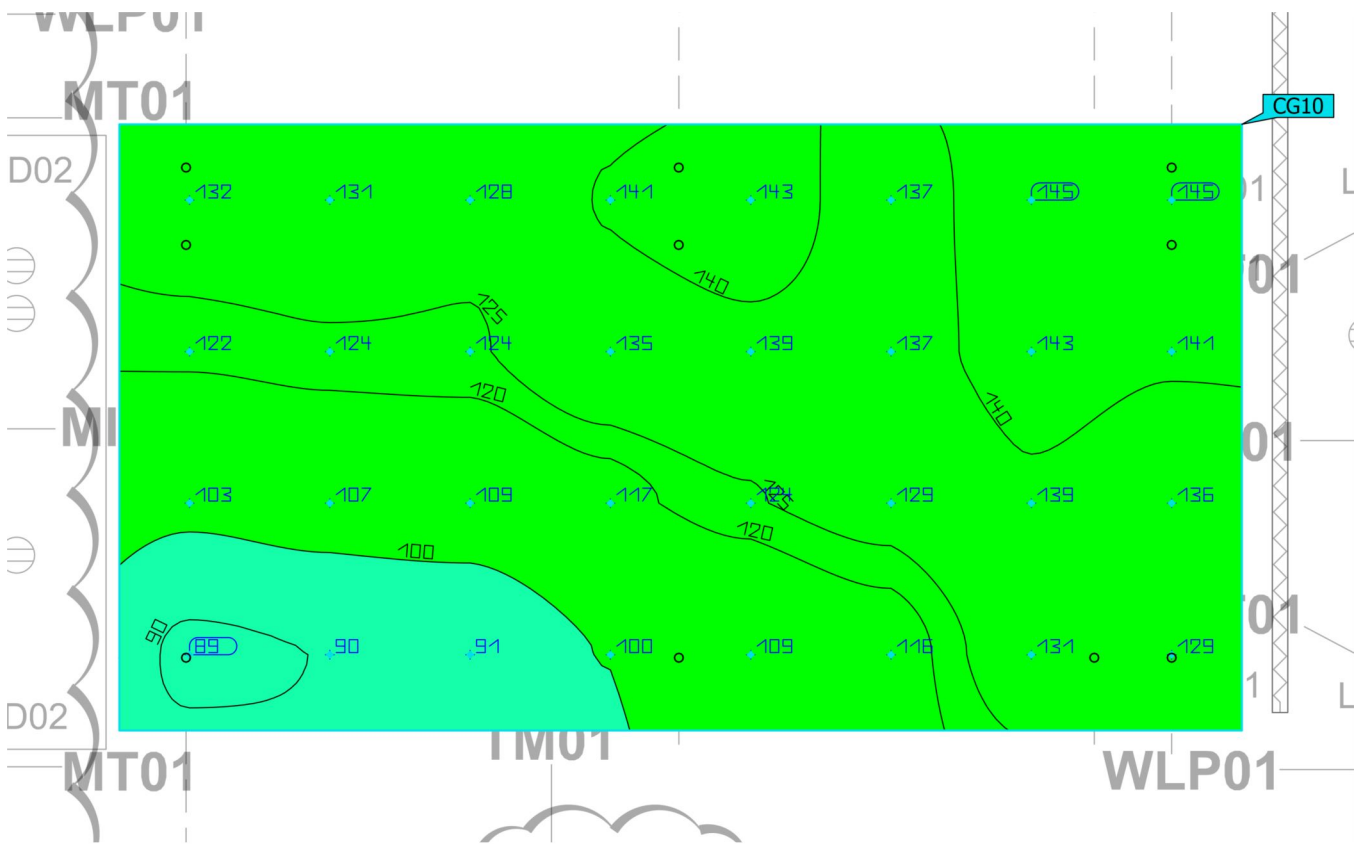
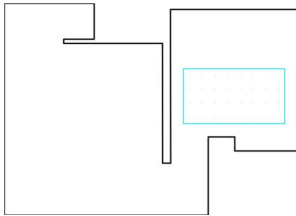

Properties	$\bar{E}$	$E_{min}$	$E_{max}$	$g_1$	$g_2$	Index
10. Junior Suite Bed room Calculation Surface Perpendicular illuminance Height: 0.000 m	125 lx	88.7 lx	145 lx	0.71	0.61	CG10

Utilization profile: DIALux presetting, Standard (office)

Building 1 · Story 1 · 12. Preparation (Light scene 1)  
**Summary**

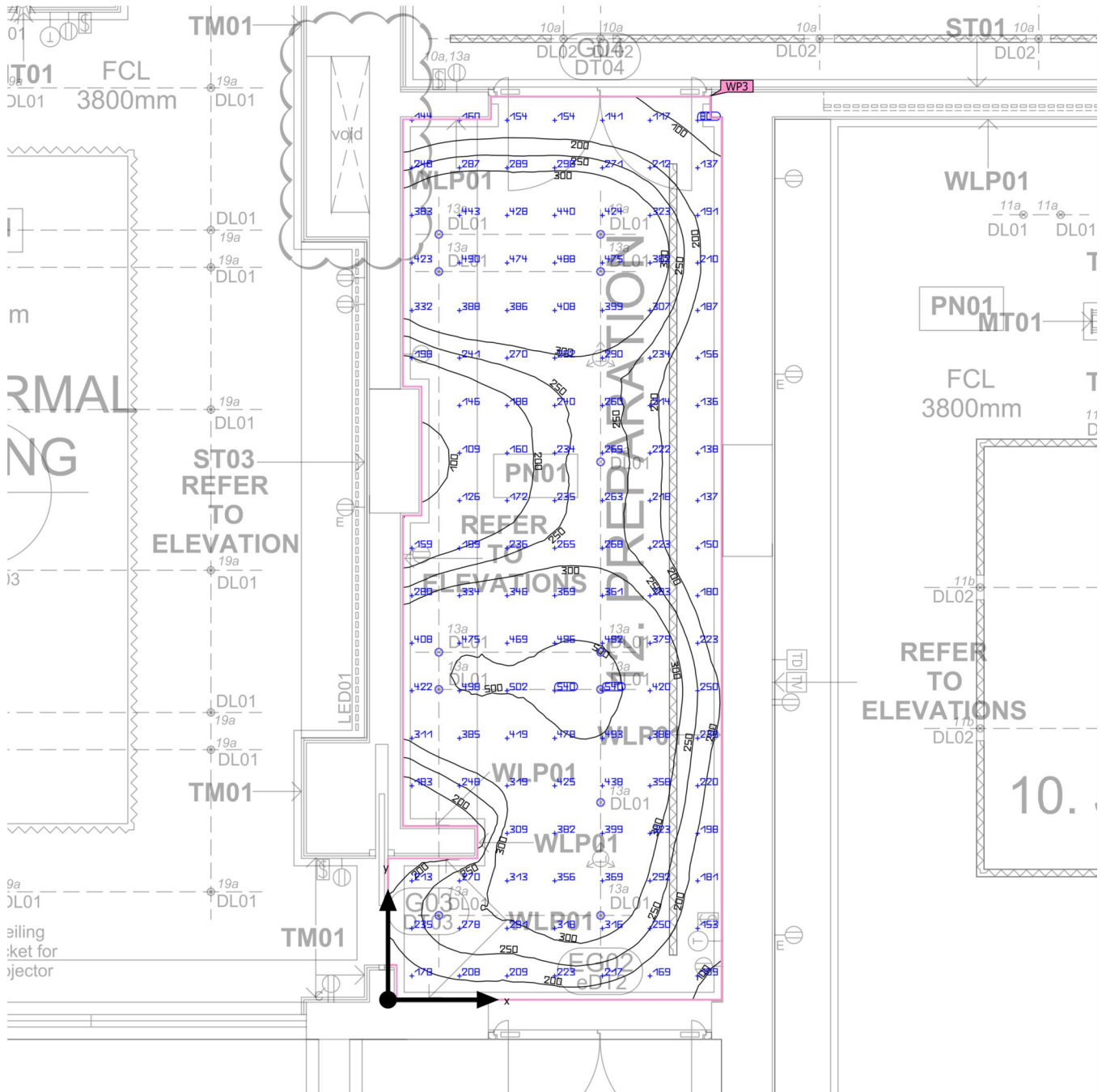

Building 1 · Story 1 · 12. Preparation (Light scene 1)

## Summary

### Results

	Symbol	Calculated	Index
Working plane	$\bar{E}_{\text{perpendicular}}$	289 lx	WP3
	$g_1$	0.21	WP3

Utilization profile: DIALux presetting, Standard (office)

### Luminaire list

pcs.	Manufacturer	Article No.	Article name	P	$\Phi$	Luminous efficacy
12	Linea Light Group	80595W30	Epitax Downlight 10W	10.0 W	681 lm	68.1 lm/W

Building 1 · Story 1 · 12. Preparation (Light scene 1)

### Calculation objects

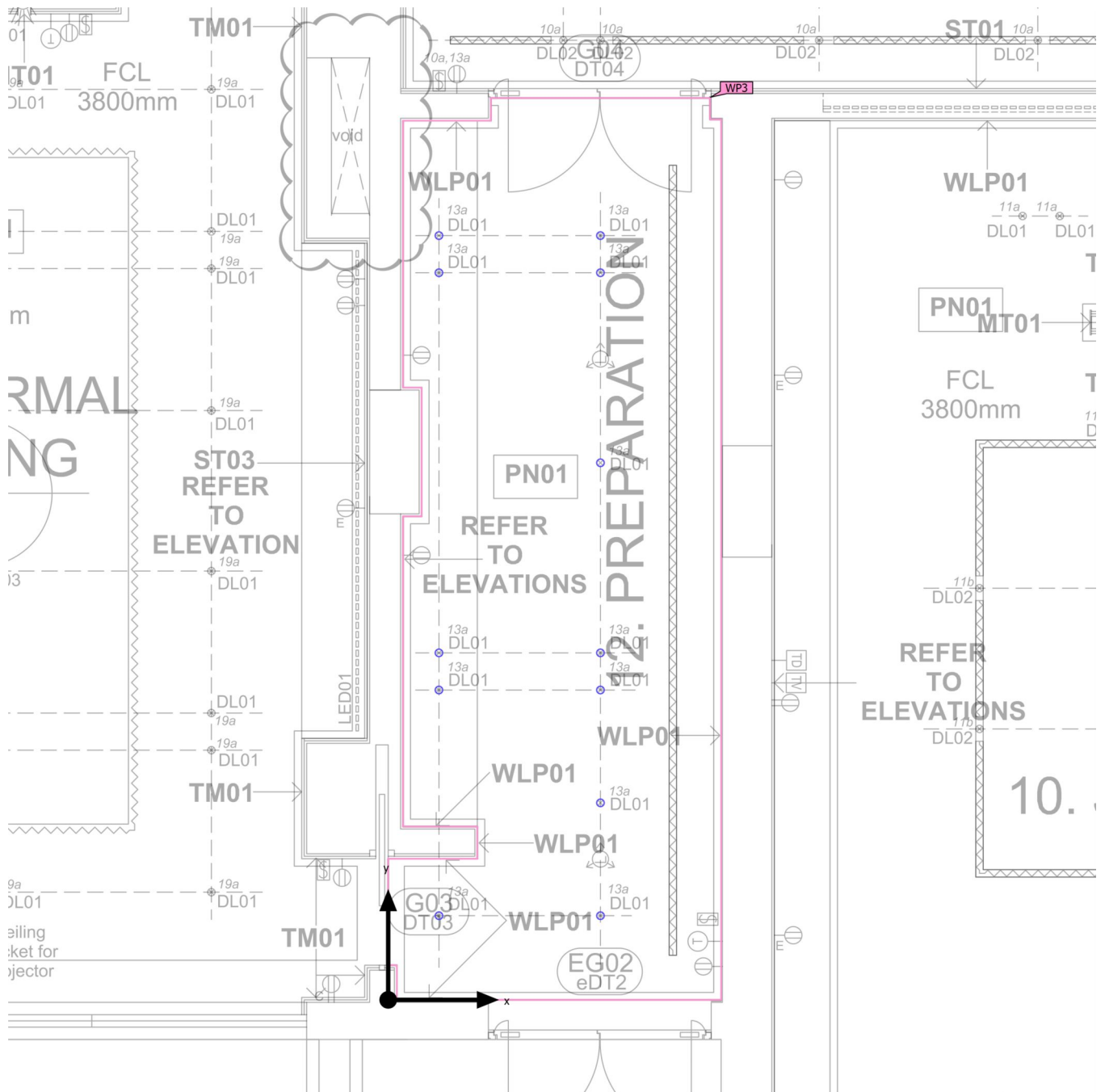

Building 1 · Story 1 · 12. Preparation (Light scene 1)

## Calculation objects

Working planes

Properties	$\bar{E}$	$E_{min}$	$E_{max}$	$g_1$	$g_2$	Index
Working plane (12. Preparation) Perpendicular illuminance (adaptive) Height: 0.800 m, Wall zone: 0.000 m	289 lx	62.1 lx	554 lx	0.21	0.11	WP3

Utilization profile: DIALux presetting, Standard (office)

Building 1 · Story 1 · 12. Preparation (Light scene 1)  
**Working plane (12. Preparation)**

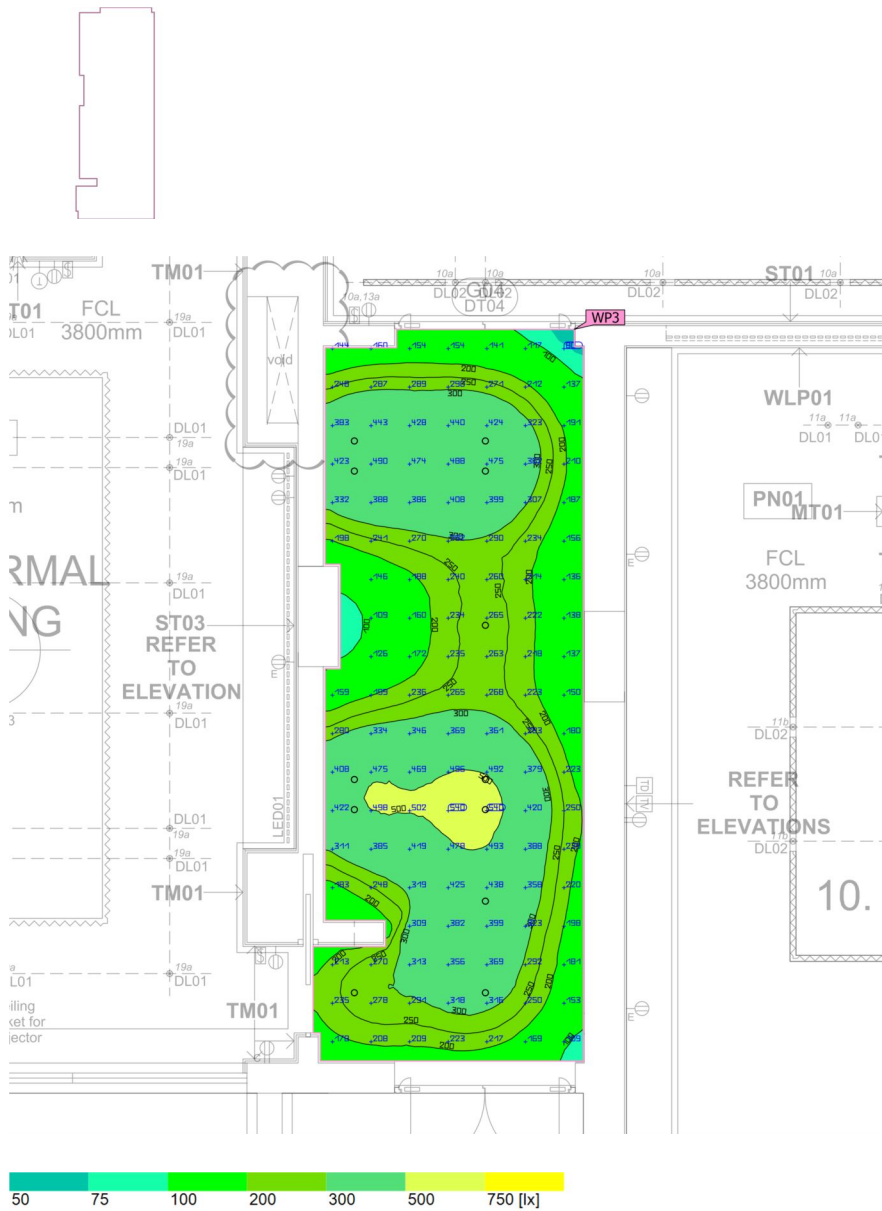

Properties	$\bar{E}$	$E_{min}$	$E_{max}$	$g_1$	$g_2$	Index
Working plane (12. Preparation) Perpendicular illuminance (adaptive) Height: 0.800 m, Wall zone: 0.000 m	289 lx	62.1 lx	554 lx	0.21	0.11	WP3

Utilization profile: DIALux presetting, Standard (office)



Building 1 · Story 1 · 16.Majlis, 15. Guest Lobby, 17. Corridor, 13.Formal Dining, 14. Guest Toilets  
(Light scene 1)

## Summary

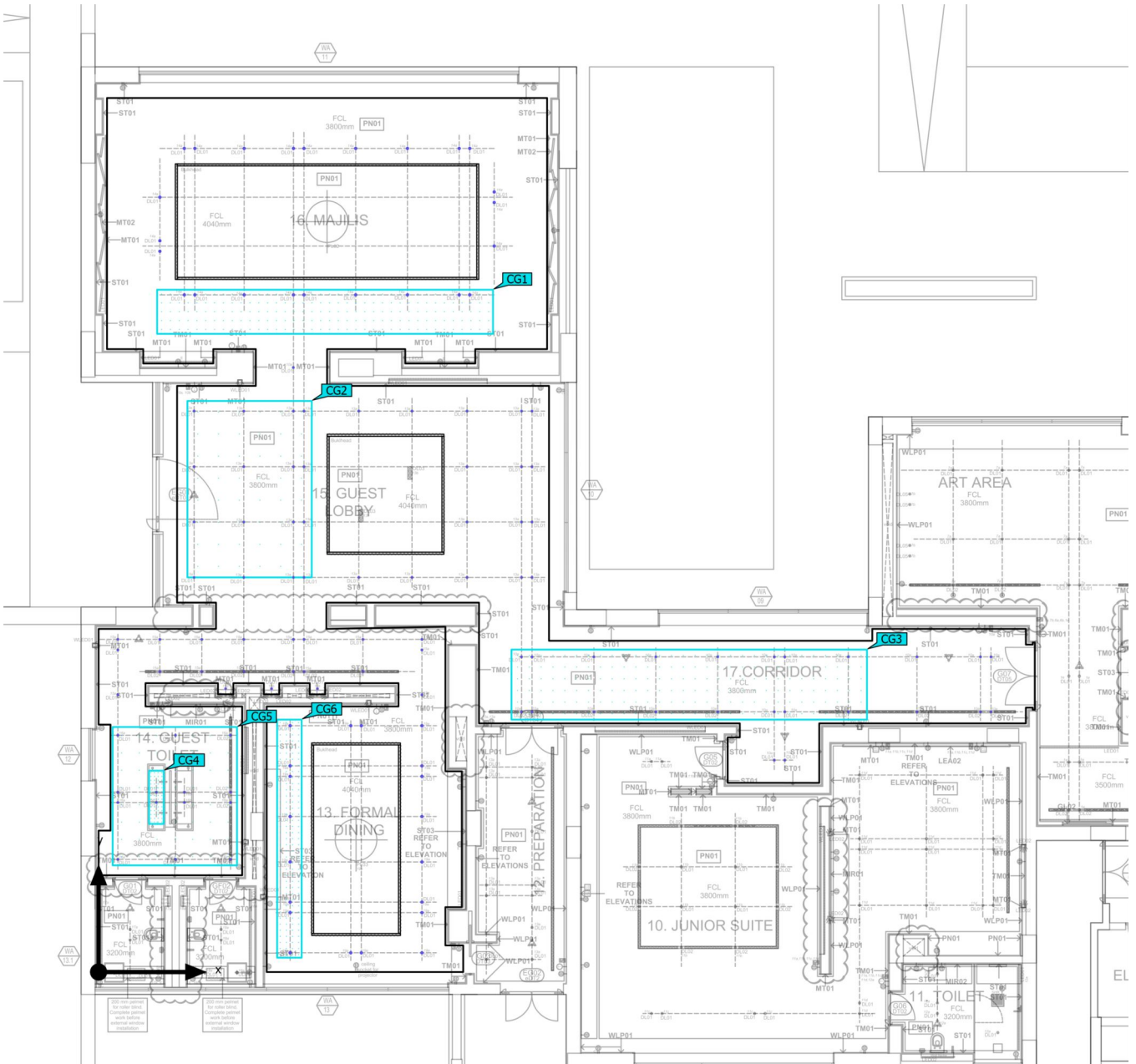

Building 1 · Story 1 · 16.Majlis, 15. Guest Lobby, 17. Corridor, 13.Formal Dining, 14. Guest Toilets  
(Light scene 1)

## Summary

### Results

Utilization profile: DIALux presetting, Standard (office)

### Luminaire list

pcs.	Manufacturer	Article No.	Article name	P	Φ	Luminous efficacy
44	Linea Light Group	80595W30	Epitax Downlight 10W	10.0 W	681 lm	68.1 lm/W
92	Linea Light Group	80640W30	Epitax Downlight 6W DC	6.0 W	351 lm	58.5 lm/W

Building 1 · Story 1 · 16.Majlis, 15. Guest Lobby, 17. Corridor, 13. Formal Dining, 14. Guest Toilets  
(Light scene 1)

### Calculation objects

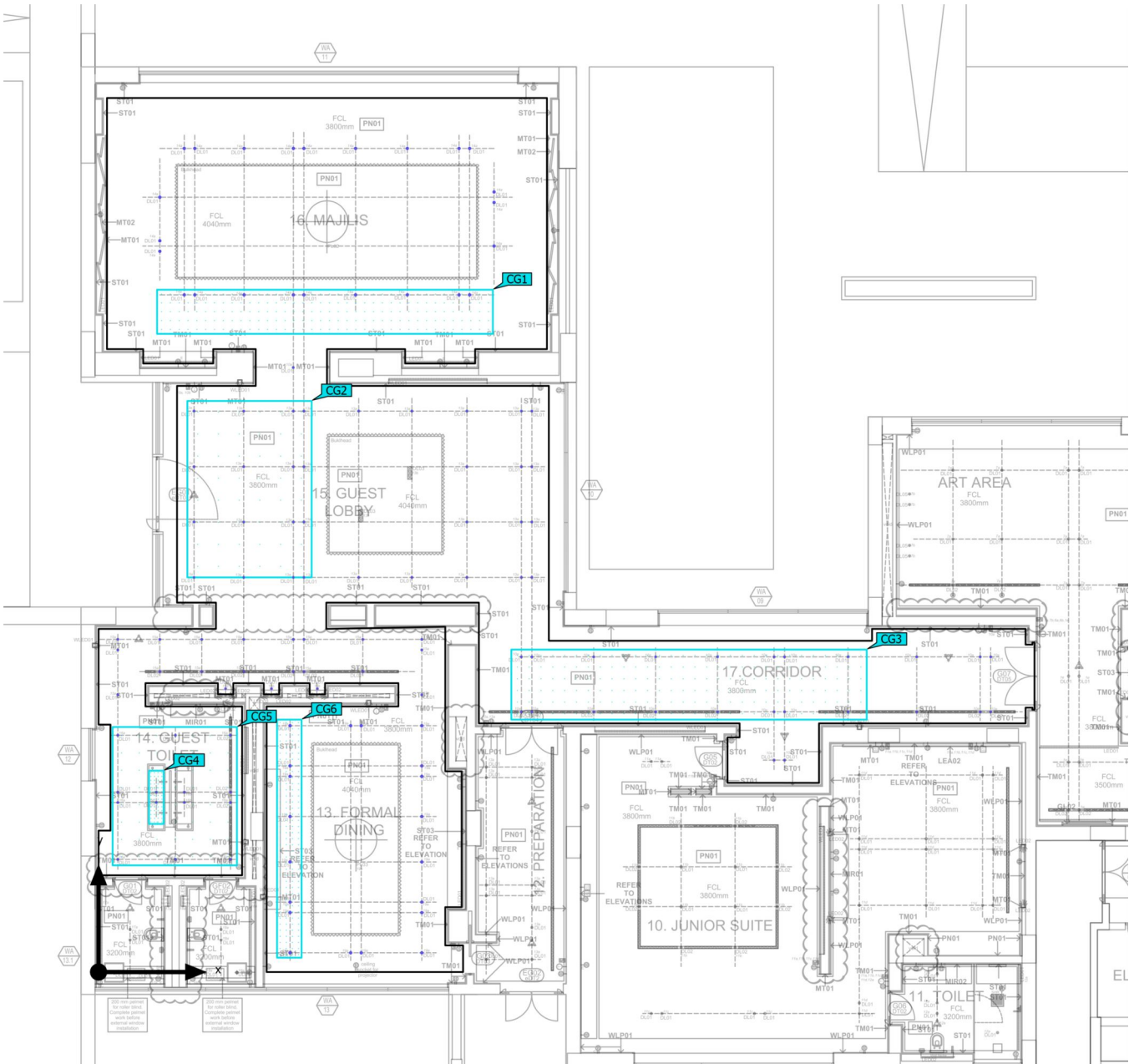

Building 1 · Story 1 · 16.Majlis, 15. Guest Lobby, 17. Corridor, 13.Formal Dining, 14. Guest Toilets  
(Light scene 1)

## Calculation objects

### Calculation surfaces

Properties	$\bar{E}$	$E_{min}$	$E_{max}$	$g_1$	$g_2$	Index
16. Majlis Calculation Surface Perpendicular illuminance Height: 0.000 m	198 lx	89.8 lx	322 lx	0.45	0.28	CG1
15. Guest Lobby Calculation Surface Perpendicular illuminance Height: 0.000 m	148 lx	101 lx	181 lx	0.68	0.56	CG2
17. Corridor Calculation Surface Perpendicular illuminance Height: 0.000 m	119 lx	89.9 lx	176 lx	0.76	0.51	CG3
14. Guest Toilet Calculation Surface Counter Perpendicular illuminance Height: 0.800 m	269 lx	221 lx	306 lx	0.82	0.72	CG4
14. Guest Toilet Calculation Surface Perpendicular illuminance Height: 0.000 m	169 lx	109 lx	244 lx	0.64	0.45	CG5
13. Formal Dining Calculation Surface Perpendicular illuminance Height: 0.000 m	291 lx	216 lx	357 lx	0.74	0.61	CG6

Utilization profile: DIALux presetting, Standard (office)

Building 1 · Story 1 · 16.Majlis, 15. Guest Lobby, 17. Corridor, 13.Formal Dining, 14. Guest Toilets  
(Light scene 1)

### 16. Majlis Caluclation Surface

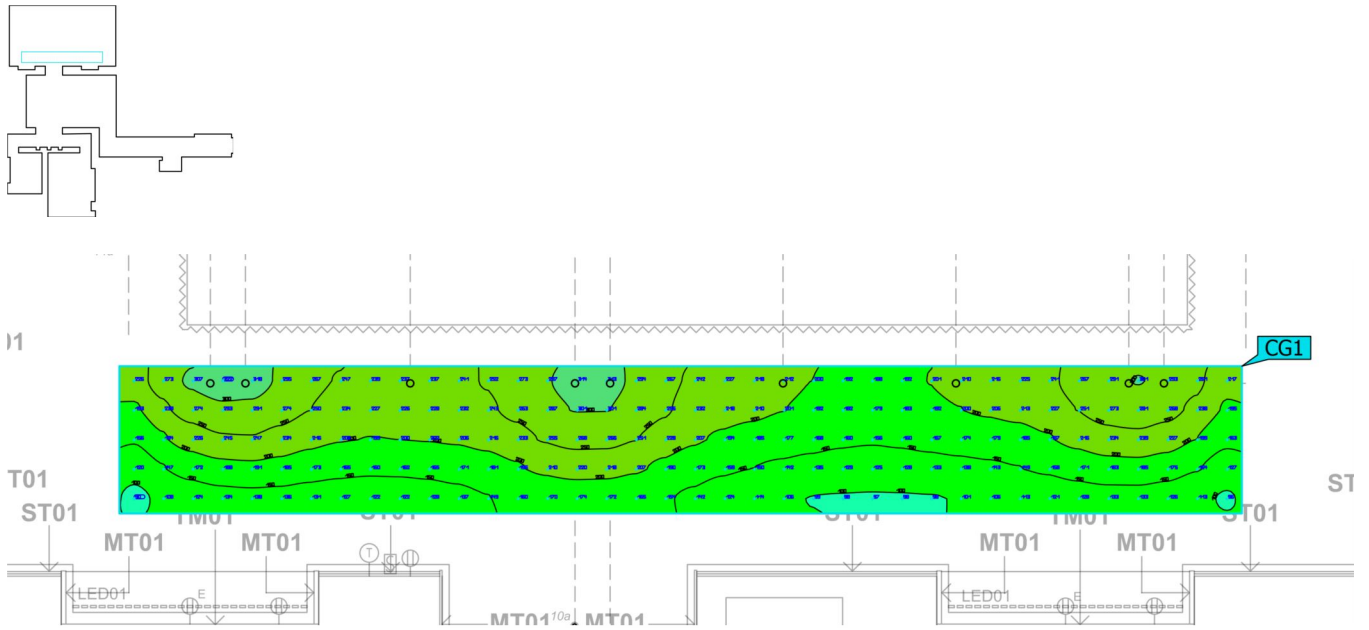

Properties	$\bar{E}$	$E_{min}$	$E_{max}$	$g_1$	$g_2$	Index
16. Majlis Caluclation Surface Perpendicular illuminance Height: 0.000 m	198 lx	89.8 lx	322 lx	0.45	0.28	CG1

Utilization profile: DIALux presetting, Standard (office)

Building 1 · Story 1 · 16.Majlis, 15. Guest Lobby, 17. Corridor, 13.Formal Dining, 14. Guest Toilets  
(Light scene 1)

### 15.Guest Lobby Calculation Surface

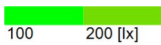
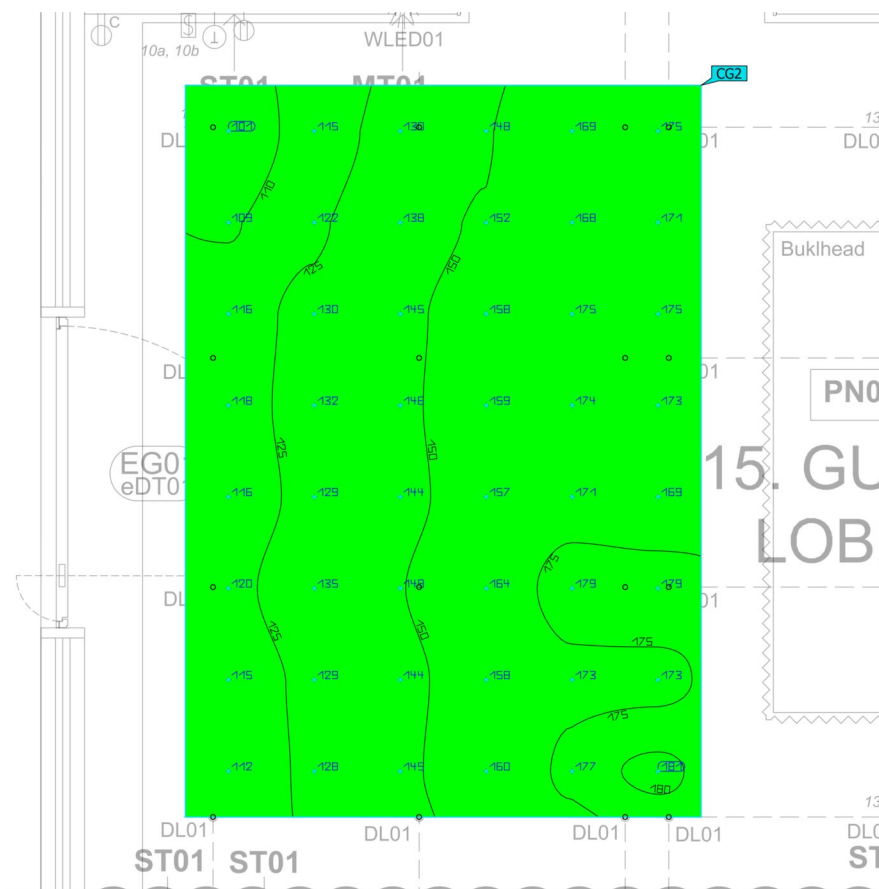
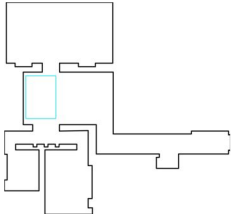

Properties	$\bar{E}$	$E_{min}$	$E_{max}$	$g_1$	$g_2$	Index
15.Guest Lobby Calculation Surface Perpendicular illuminance Height: 0.000 m	148 lx	101 lx	181 lx	0.68	0.56	CG2

Utilization profile: DIALux presetting, Standard (office)

Building 1 · Story 1 · 16.Majlis, 15. Guest Lobby, 17. Corridor, 13.Formal Dining, 14. Guest Toilets  
(Light scene 1)

### 17. Corridor Calculation Surface

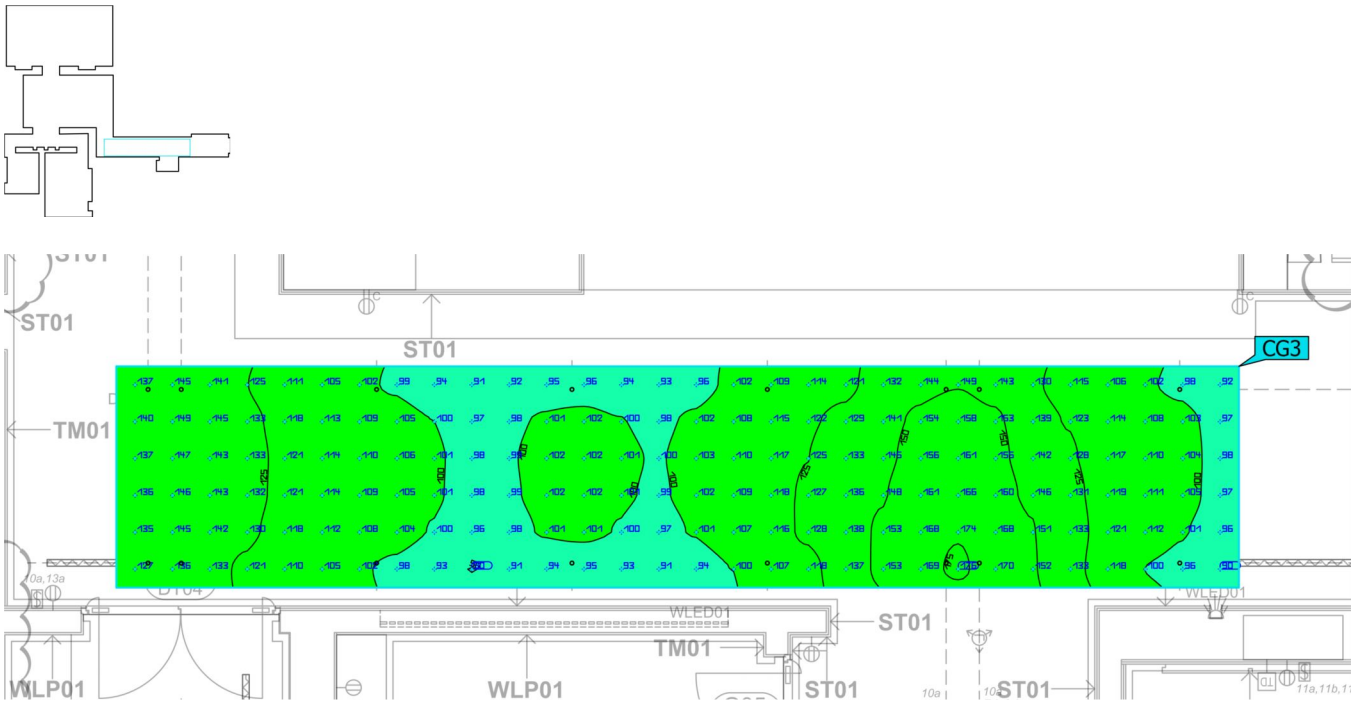

Properties	$\bar{E}$	$E_{min}$	$E_{max}$	$g_1$	$g_2$	Index
17. Corridor Calculation Surface Perpendicular illuminance Height: 0.000 m	119 lx	89.9 lx	176 lx	0.76	0.51	CG3

Utilization profile: DIALux presetting, Standard (office)

Building 1 · Story 1 · 16.Majlis, 15. Guest Lobby, 17. Corridor, 13.Formal Dining, 14. Guest Toilets  
(Light scene 1)

### 14. Guest Toilet Calculation Surface Counter

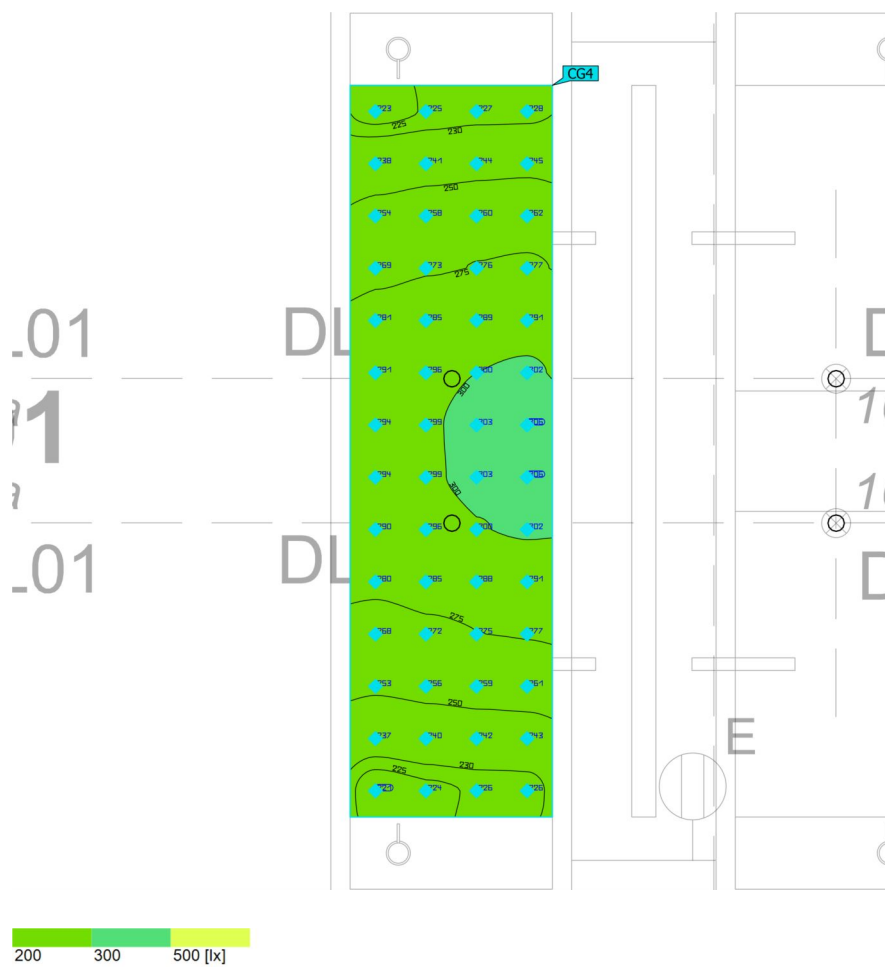
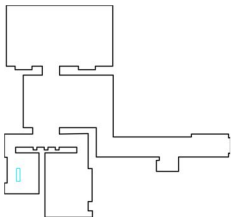

Properties	$\bar{E}$	$E_{min}$	$E_{max}$	$g_1$	$g_2$	Index
14. Guest Toilet Calculation Surface Counter Perpendicular illuminance Height: 0.800 m	269 lx	221 lx	306 lx	0.82	0.72	CG4

Utilization profile: DIALux presetting, Standard (office)



Building 1 · Story 1 · 16.Majlis, 15. Guest Lobby, 17. Corridor, 13.Formal Dining, 14. Guest Toilets  
(Light scene 1)

### 14. Guest Toilet Calculation Surface

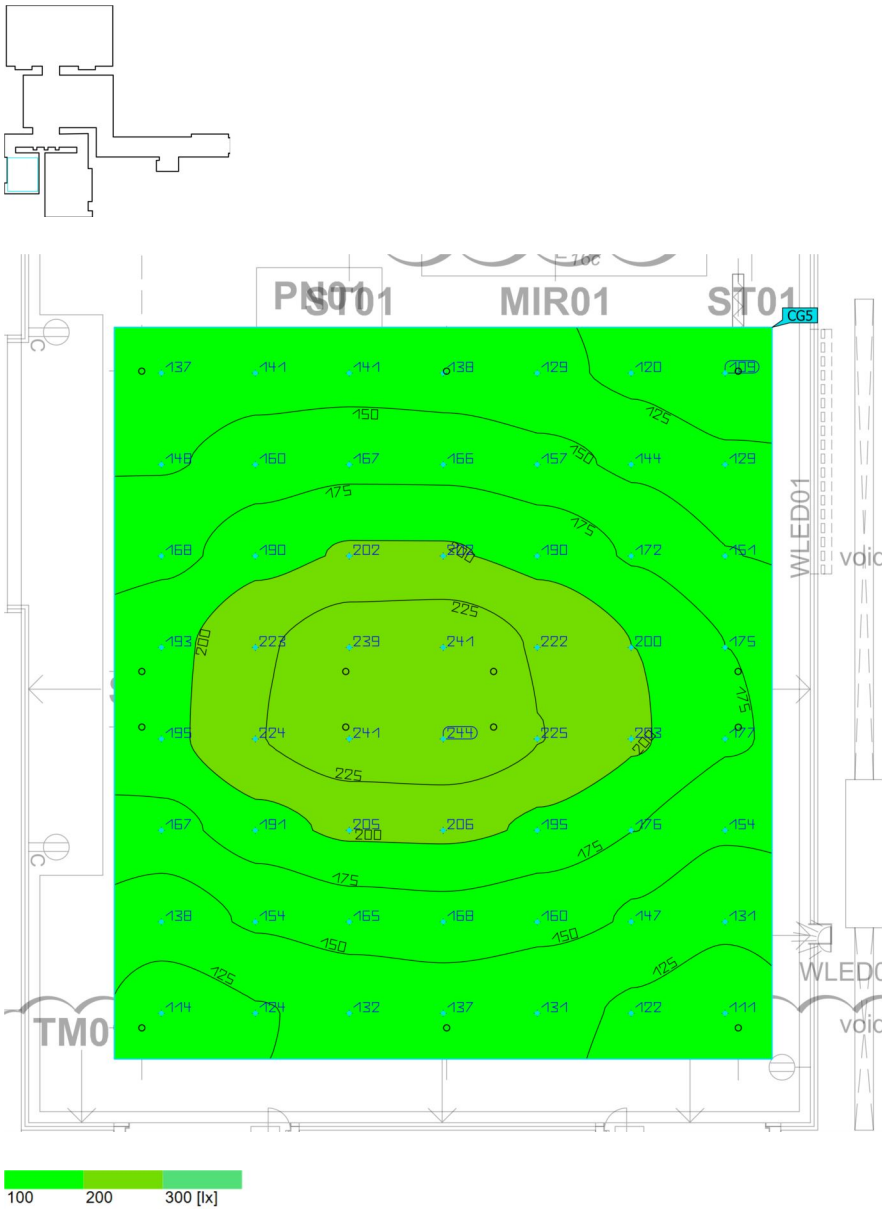

Properties	$\bar{E}$	$E_{min}$	$E_{max}$	$g_1$	$g_2$	Index
14. Guest Toilet Calculation Surface Perpendicular illuminance Height: 0.000 m	169 lx	109 lx	244 lx	0.64	0.45	CG5

Utilization profile: DIALux presetting, Standard (office)

Building 1 · Story 1 · 16.Majlis, 15. Guest Lobby, 17. Corridor, 13. Formal Dining, 14. Guest Toilets  
(Light scene 1)

### 13. Formal Dining Calculation Surface

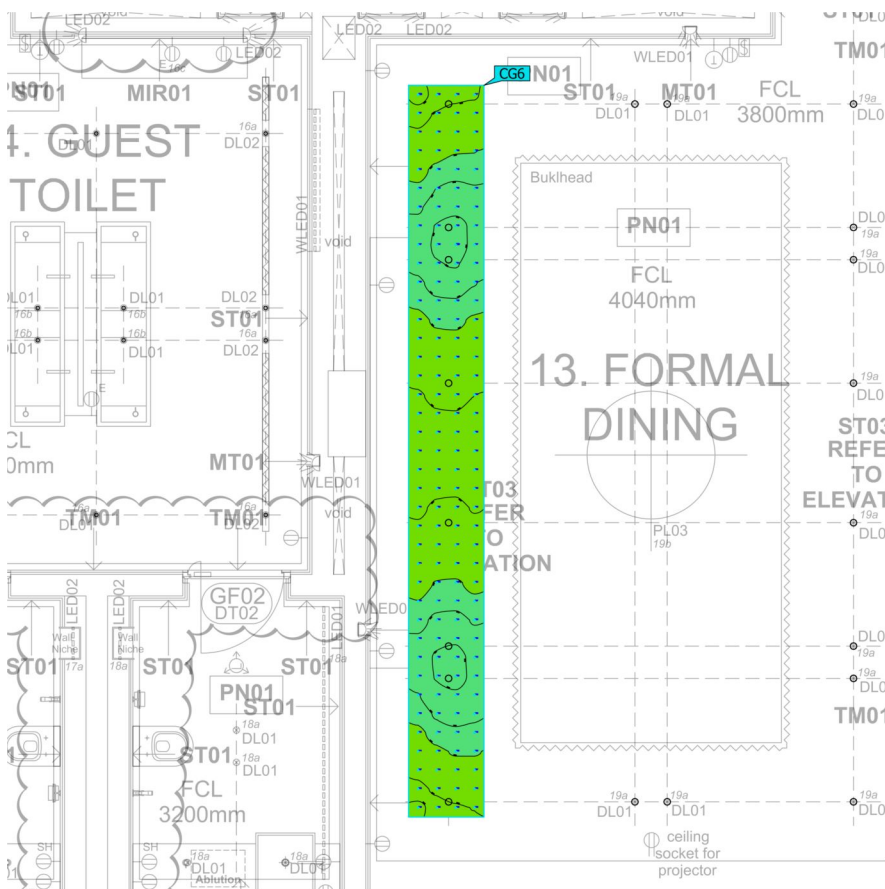
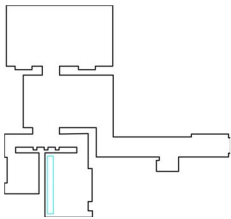

Properties	$\bar{E}$	$E_{min}$	$E_{max}$	$g_1$	$g_2$	Index
13. Formal Dining Calculation Surface Perpendicular illuminance Height: 0.000 m	291 lx	216 lx	357 lx	0.74	0.61	CG6

Utilization profile: DIALux presetting, Standard (office)

Building 1 · Story 1 · 22. Toilet (Light scene 1)

### Summary

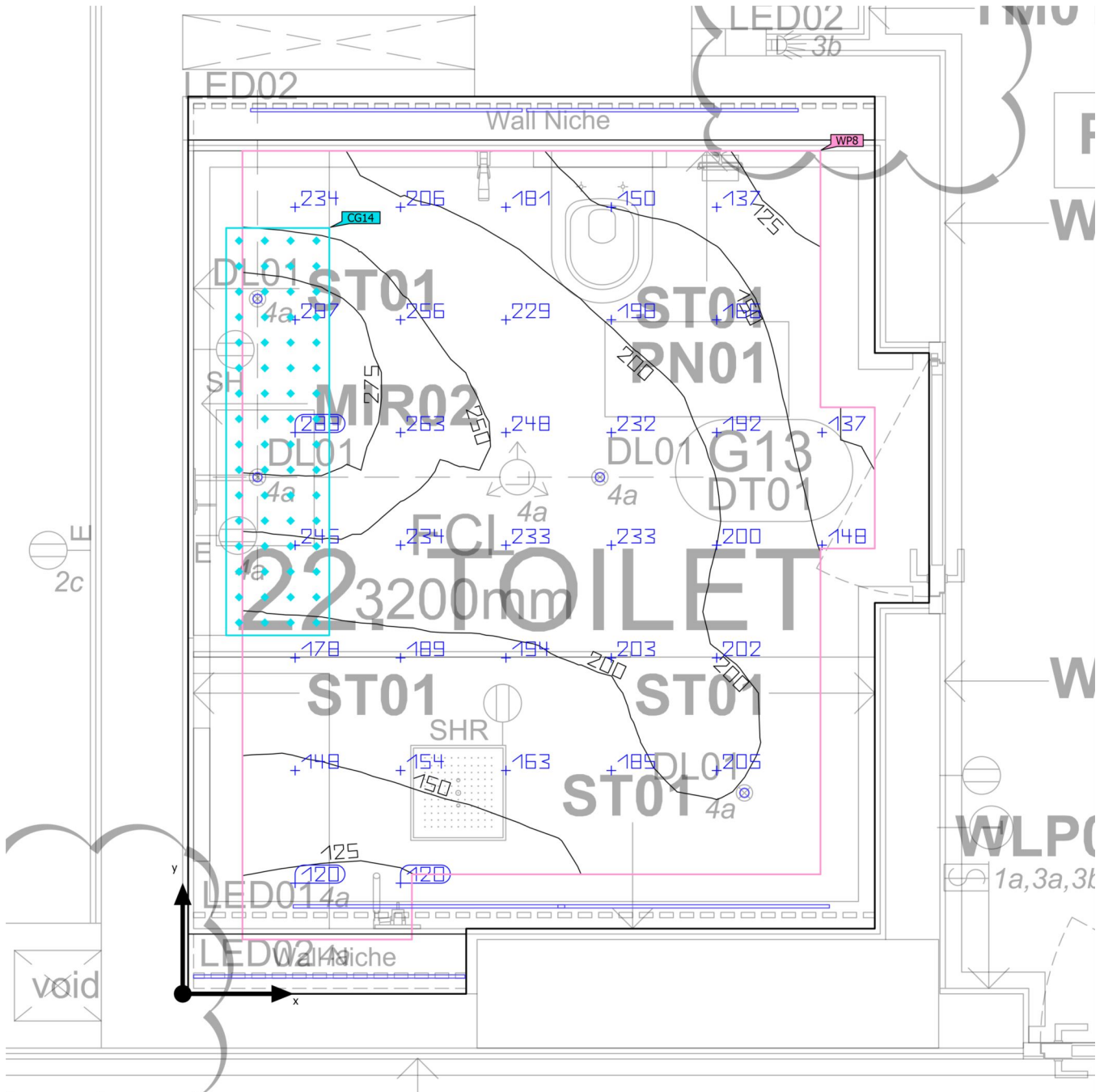

Building 1 · Story 1 · 22. Toilet (Light scene 1)

## Summary

### Results

	Symbol	Calculated	Index
Working plane	$\bar{E}_{\text{perpendicular}}$	197 lx	WP8
	$g_1$	0.56	WP8

Utilization profile: DIALux presetting, Standard (office)

### Luminaire list

pcs.	Manufacturer	Article No.	Article name	P	$\Phi$	Luminous efficacy
4	Linea Light Group	80640W30	Epitax Downlight 6W DC	6.0 W	351 lm	58.5 lm/W
5	Linea Light Group	98779	PU_C Plus - LED strip, IP66 - Led 12.6 W	12.6 W	1298 lm	103.0 lm/W

Building 1 · Story 1 · 22. Toilet (Light scene 1)

### Calculation objects

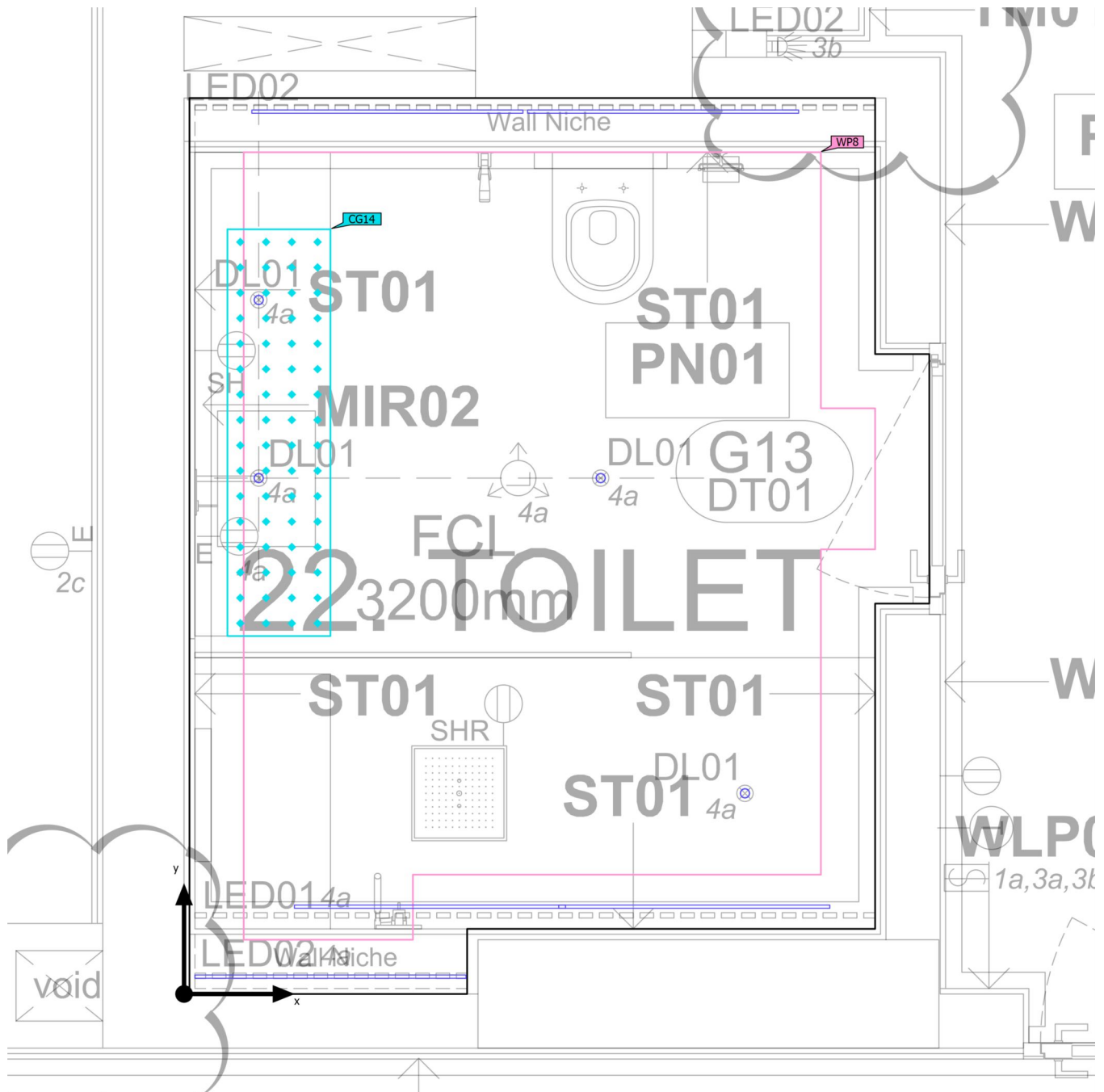

Building 1 · Story 1 · 22. Toilet (Light scene 1)

## Calculation objects

### Working planes

Properties	$\bar{E}$	$E_{min}$	$E_{max}$	$g_1$	$g_2$	Index
Working plane (22. Toilet) Perpendicular illuminance (adaptive) Height: 0.800 m, Wall zone: 0.200 m	197 lx	111 lx	300 lx	0.56	0.37	WP8

### Calculation surfaces

Properties	$\bar{E}$	$E_{min}$	$E_{max}$	$g_1$	$g_2$	Index
22. Toilet Counter Calculation Surface Perpendicular illuminance Height: 0.800 m	262 lx	180 lx	298 lx	0.69	0.60	CG14

Utilization profile: DIALux presetting, Standard (office)

Building 1 · Story 1 · 22. Toilet (Light scene 1)  
**Working plane (22. Toilet)**

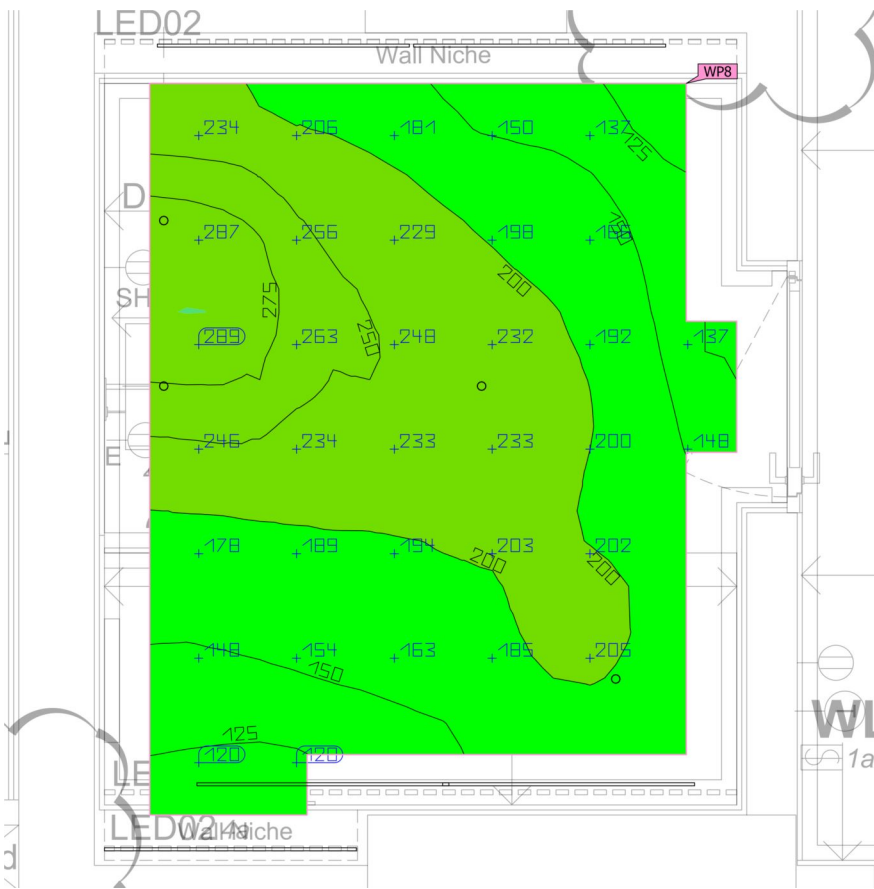
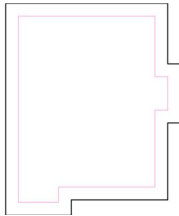

Properties	$\bar{E}$	$E_{min}$	$E_{max}$	$g_1$	$g_2$	Index
Working plane (22. Toilet) Perpendicular illuminance (adaptive) Height: 0.800 m, Wall zone: 0.200 m	197 lx	111 lx	300 lx	0.56	0.37	WP8

Utilization profile: DIALux presetting, Standard (office)

Building 1 · Story 1 · 22. Toilet (Light scene 1)

## 22. Toilet Counter Calculation Surface

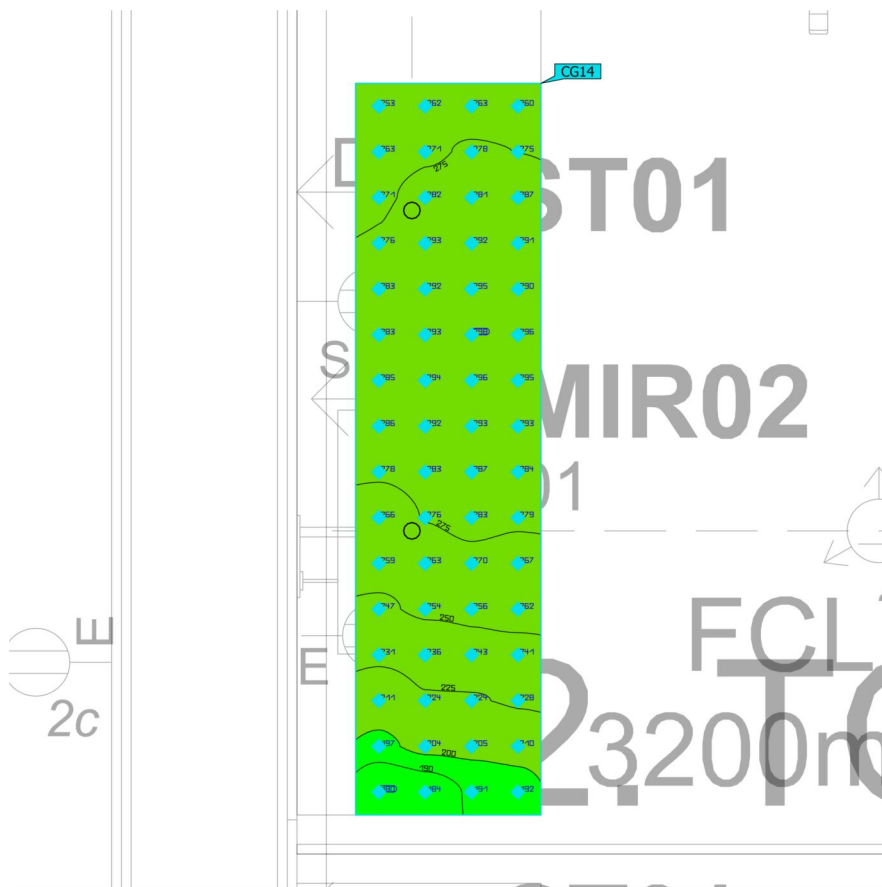
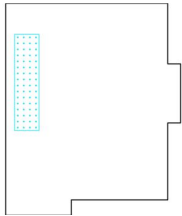

Properties	$\bar{E}$	$E_{min}$	$E_{max}$	$g_1$	$g_2$	Index
22. Toilet Counter Calculation Surface Perpendicular illuminance Height: 0.800 m	262 lx	180 lx	298 lx	0.69	0.60	CG14

Utilization profile: DIALux presetting, Standard (office)



Building 1 · Story 1 · Art Area, 7. Open Kitchen, Family Dining, 5. Play Room, 9. Corridor, 3. Family Living (Light scene 1)

## Summary

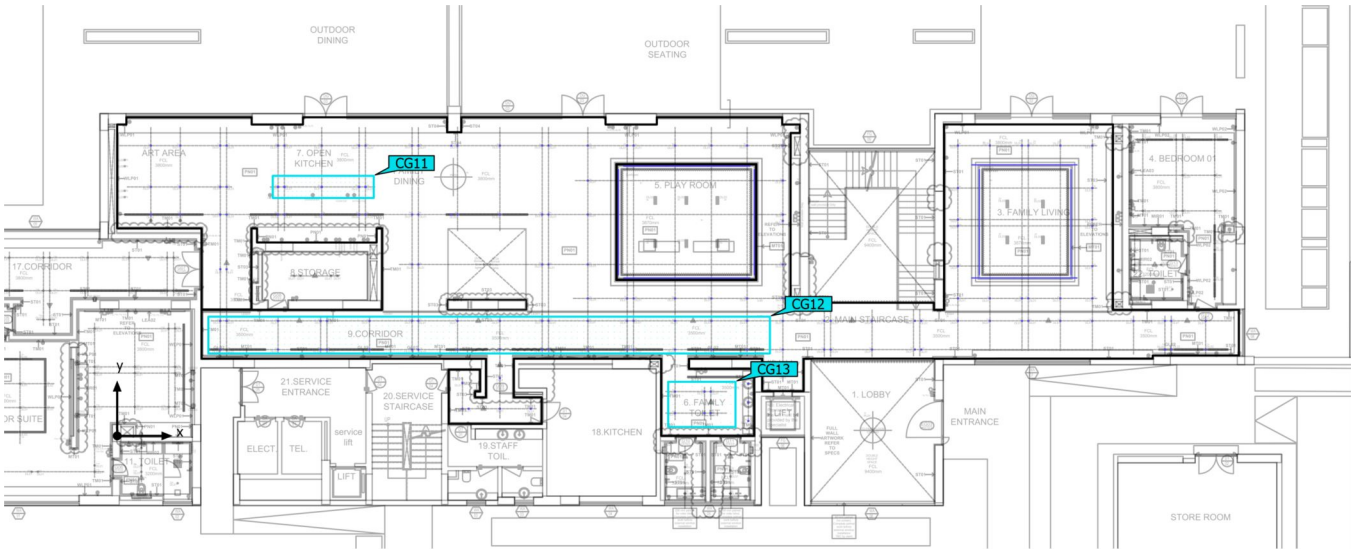



Building 1 · Story 1 · Art Area, 7. OPen Kitchen, Family Dining, 5. PLayer Room, 9. Corridor, 3. Family Living (Light scene 1)

## Summary

### Results

Utilization profile: DIALux presetting, Standard (office)

### Luminaire list

pcs.	Manufacturer	Article No.	Article name	P	Φ	Luminous efficacy
5	Linea Light Group	80595W30	Epitax Downlight 10W	10.0 W	681 lm	68.1 lm/W
159	Linea Light Group	80640W30	Epitax Downlight 6W DC	6.0 W	351 lm	58.5 lm/W
42	Linea Light Group	98639	Ribbon Plus - LED strip, IP20 - 12.6 W	12.6 W	1594 lm	126.5 lm/W

Building 1 · Story 1 · Art Area, 7. OPen Kitchen, Family Dining, 5. PLayer Room, 9. Corridor, 3. Family Living (Light scene 1)

### Calculation objects

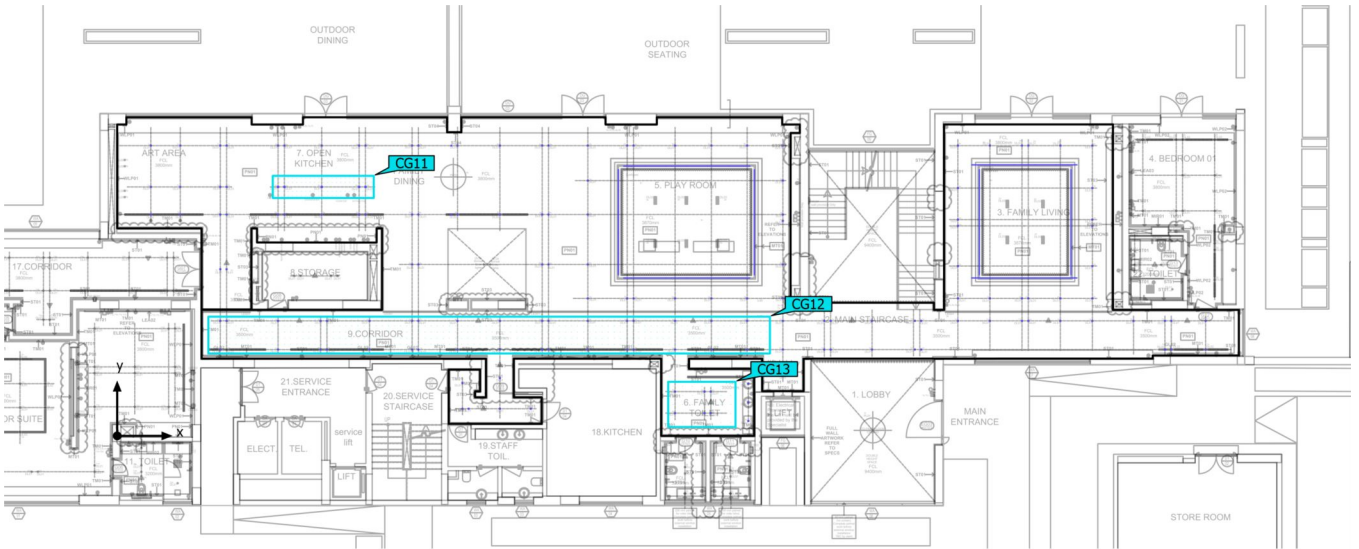

Building 1 · Story 1 · Art Area, 7. OPen Kitchen, Family Dining, 5. PLayer Room, 9. Corridor, 3. Family Living (Light scene 1)

## Calculation objects

### Calculation surfaces

Properties	$\bar{E}$	$E_{min}$	$E_{max}$	$g_1$	$g_2$	Index
7. Open Kitchen Counter Calculation Surface Perpendicular illuminance Height: 0.800 m	297 lx	184 lx	454 lx	0.62	0.41	CG11
09. Corridor Calculation Surface Perpendicular illuminance Height: 0.000 m	135 lx	62.5 lx	246 lx	0.46	0.25	CG12
6. Family toilet Calculation surface Perpendicular illuminance Height: 0.000 m	162 lx	99.9 lx	212 lx	0.62	0.47	CG13

Utilization profile: DIALux presetting, Standard (office)

Building 1 · Story 1 · Art Area, 7. Open Kitchen, Family Dining, 5. PPlay Room, 9. Corridor, 3. Family Living (Light scene 1)

## 7. Open Kitchen Counter Calculation Surface

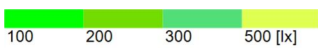
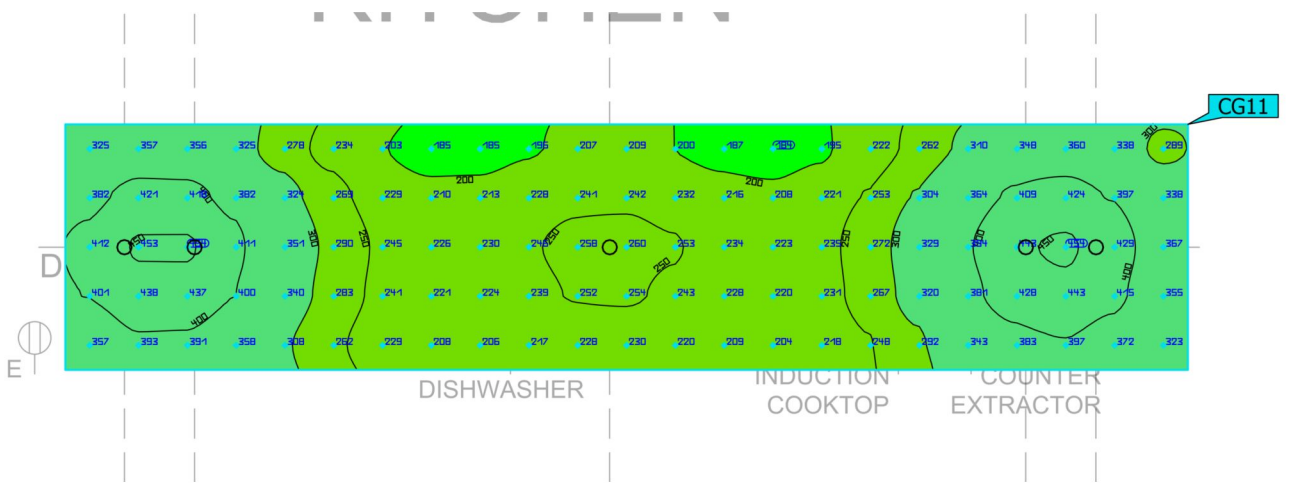
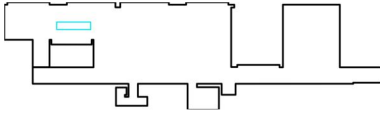

Properties	$\bar{E}$	$E_{min}$	$E_{max}$	$g_1$	$g_2$	Index
7. Open Kitchen Counter Calculation Surface Perpendicular illuminance Height: 0.800 m	297 lx	184 lx	454 lx	0.62	0.41	CG11

Utilization profile: DIALux presetting, Standard (office)

Building 1 · Story 1 · Art Area, 7. Open Kitchen, Family Dining, 5. Play Room, 9. Corridor, 3. Family Living (Light scene 1)

### 09. Corridor Calculation Surface

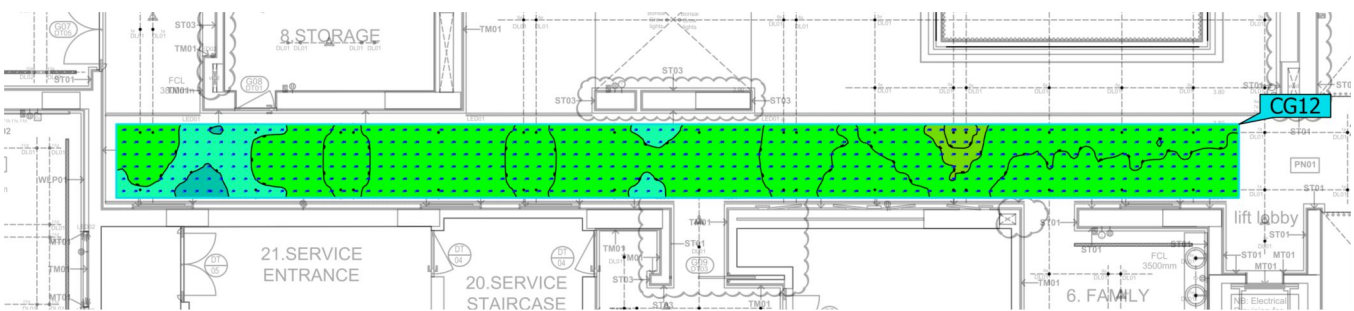
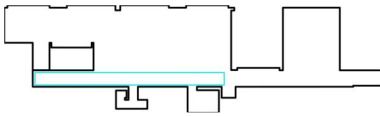

Properties	$\bar{E}$	$E_{min}$	$E_{max}$	$g_1$	$g_2$	Index
09. Corridor Calculation Surface Perpendicular illuminance Height: 0.000 m	135 lx	62.5 lx	246 lx	0.46	0.25	CG12

Utilization profile: DIALux presetting, Standard (office)

Building 1 · Story 1 · Art Area, 7. OPen Kitchen, Family Dining, 5. PPlay Room, 9. Corridor, 3. Family Living (Light scene 1)

### 6. Family toilet Calculation surface

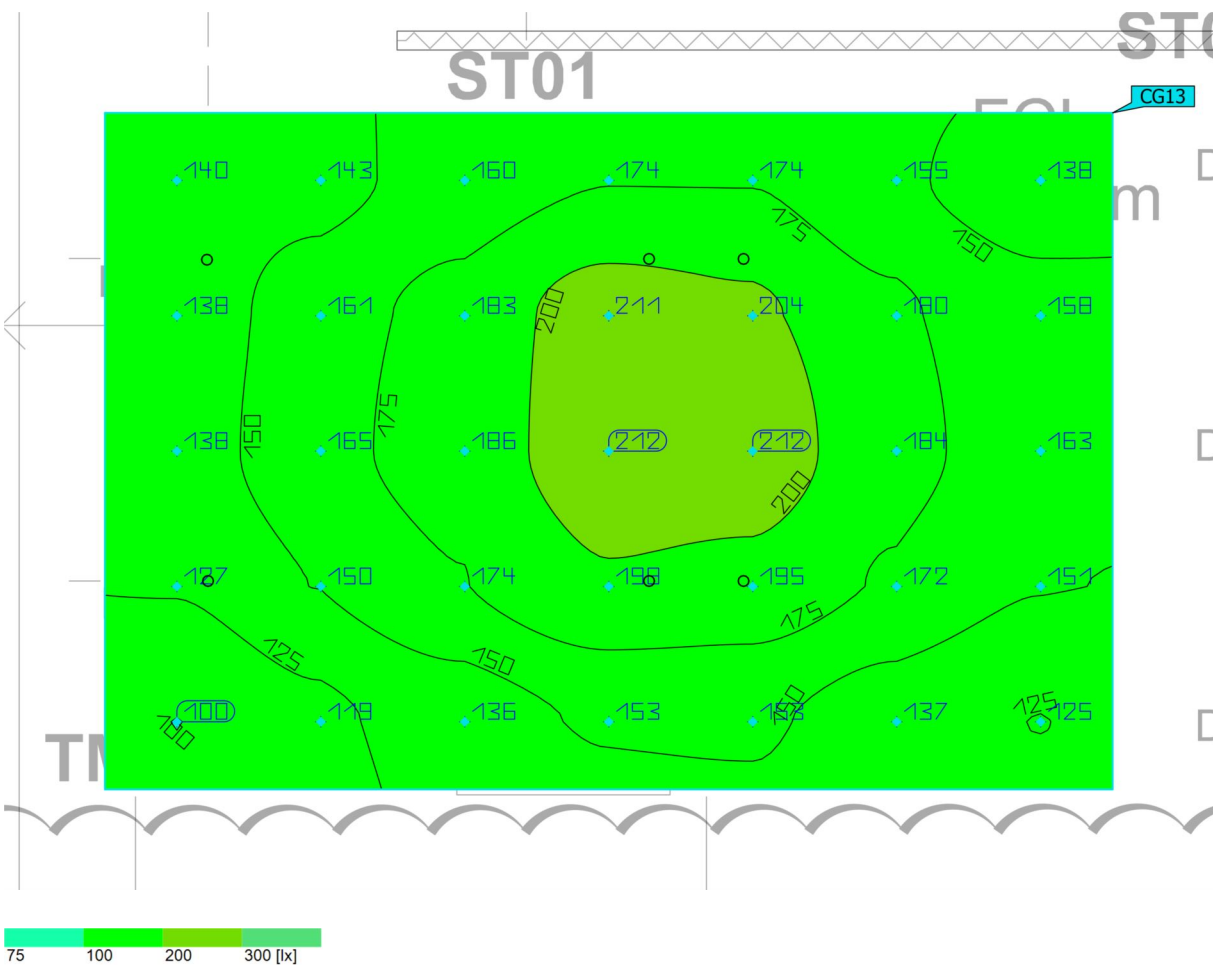
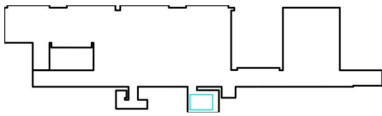

Properties	$\bar{E}$	$E_{min}$	$E_{max}$	$g_1$	$g_2$	Index
6. Family toilet Calculation surface Perpendicular illuminance Height: 0.000 m	162 lx	99.9 lx	212 lx	0.62	0.47	CG13

Utilization profile: DIALux presetting, Standard (office)

Building 1 · Story 1 · Family Toilet 1 (Light scene 1)

### Summary

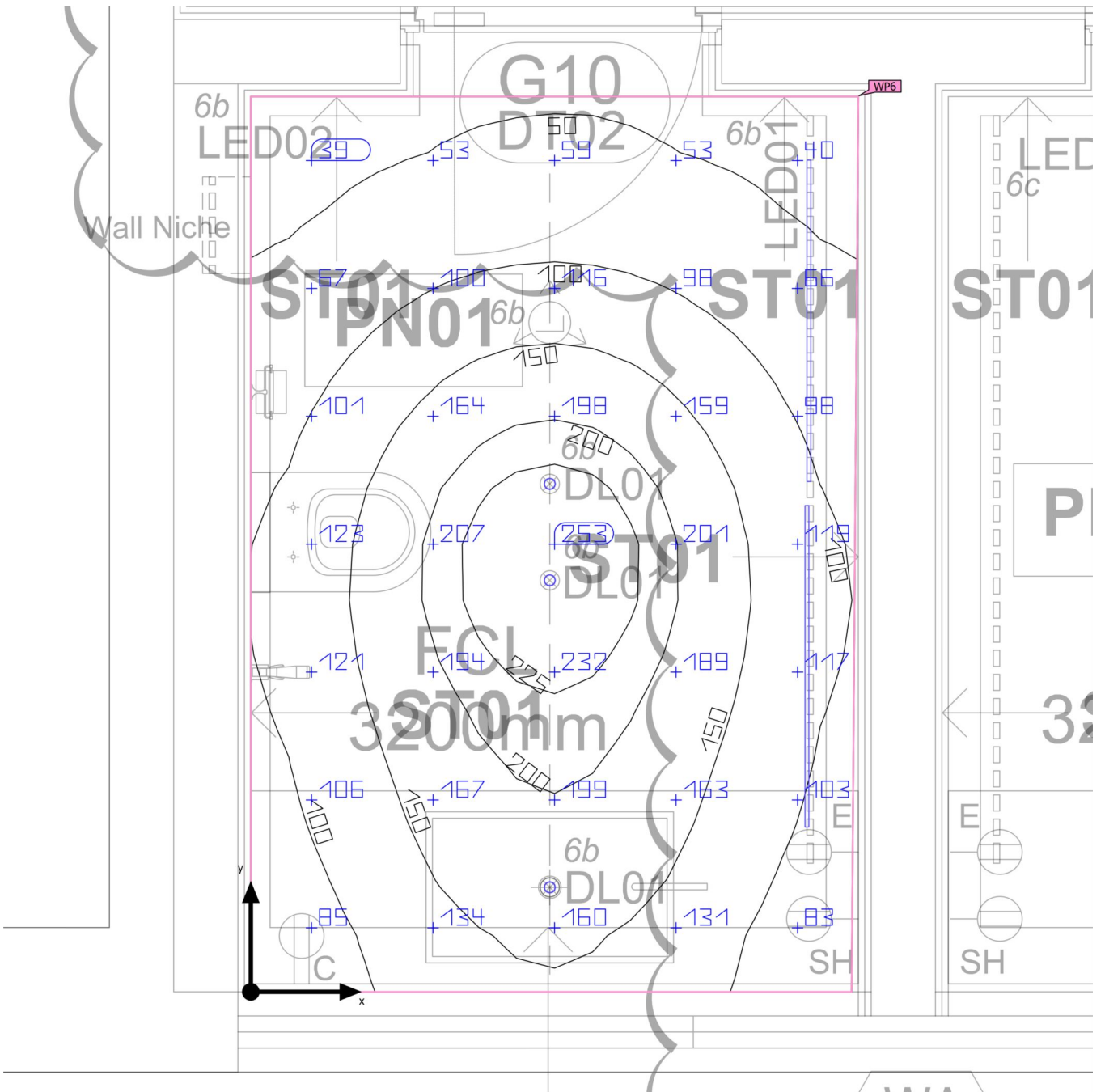



Building 1 · Story 1 · Family Toilet 1 (Light scene 1)

## Summary

### Results

	Symbol	Calculated	Index
Working plane	$\bar{E}_{\text{perpendicular}}$	128 lx	WP6
	$g_1$	0.26	WP6

Utilization profile: DIALux presetting, Standard (office)

### Luminaire list

pcs.	Manufacturer	Article No.	Article name	P	$\Phi$	Luminous efficacy
3	Linea Light Group	80640W30	Epitax Downlight 6W DC	6.0 W	351 lm	58.5 lm/W
2	Linea Light Group	98779	PU_C Plus - LED strip, IP66 - Led 12.6 W	12.6 W	1298 lm	103.0 lm/W

Building 1 · Story 1 · Family Toilet 1 (Light scene 1)

### Calculation objects

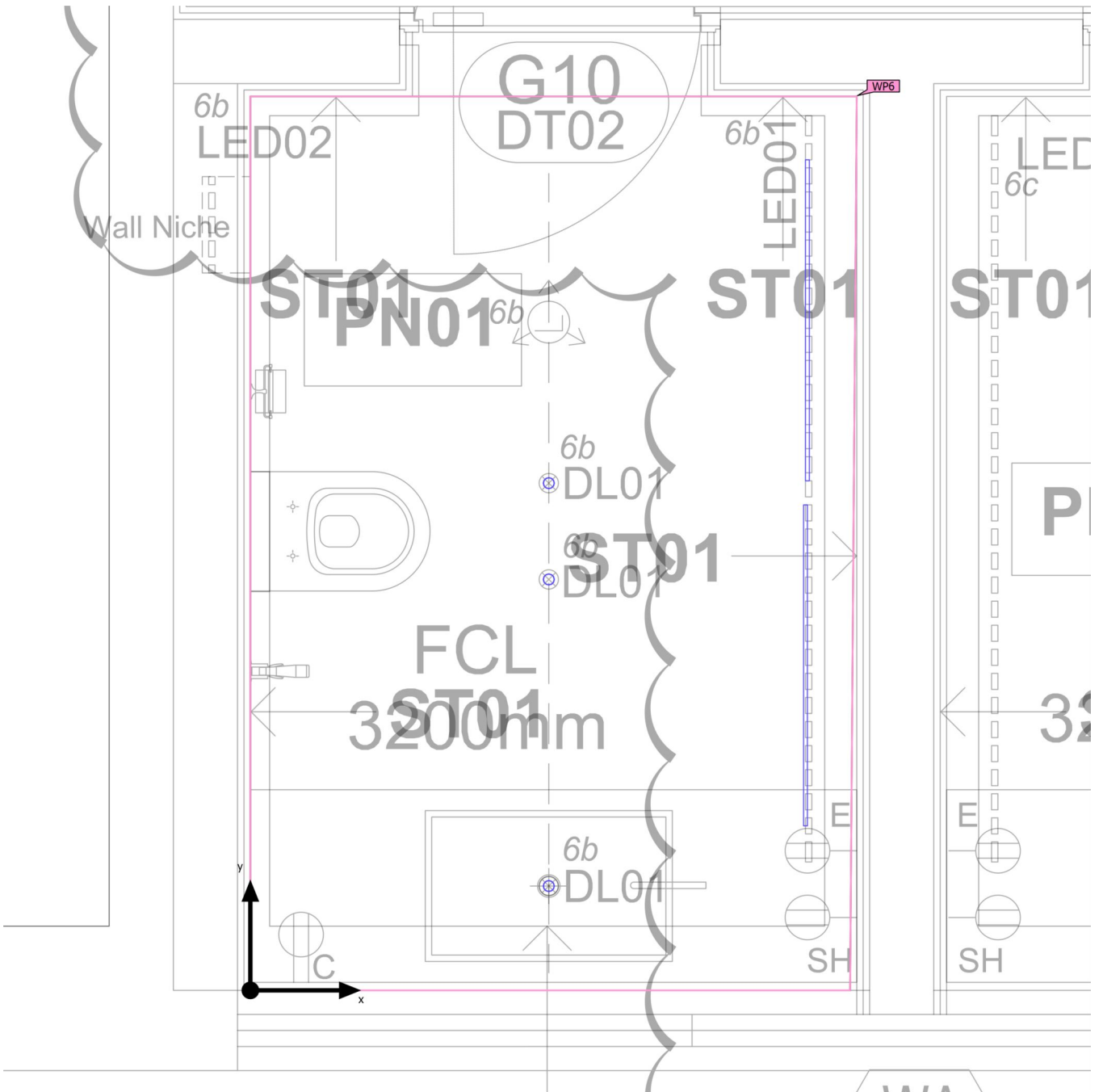

Building 1 · Story 1 · Family Toilet 1 (Light scene 1)

## Calculation objects

### Working planes

Properties	$\bar{E}$	$E_{min}$	$E_{max}$	$g_1$	$g_2$	Index
Working plane (Family Toilet 1) Perpendicular illuminance (adaptive) Height: 0.800 m, Wall zone: 0.000 m	128 lx	33.6 lx	250 lx	0.26	0.13	WP6

Utilization profile: DIALux presetting, Standard (office)

Building 1 · Story 1 · Family Toilet 1 (Light scene 1)

### Working plane (Family Toilet 1)

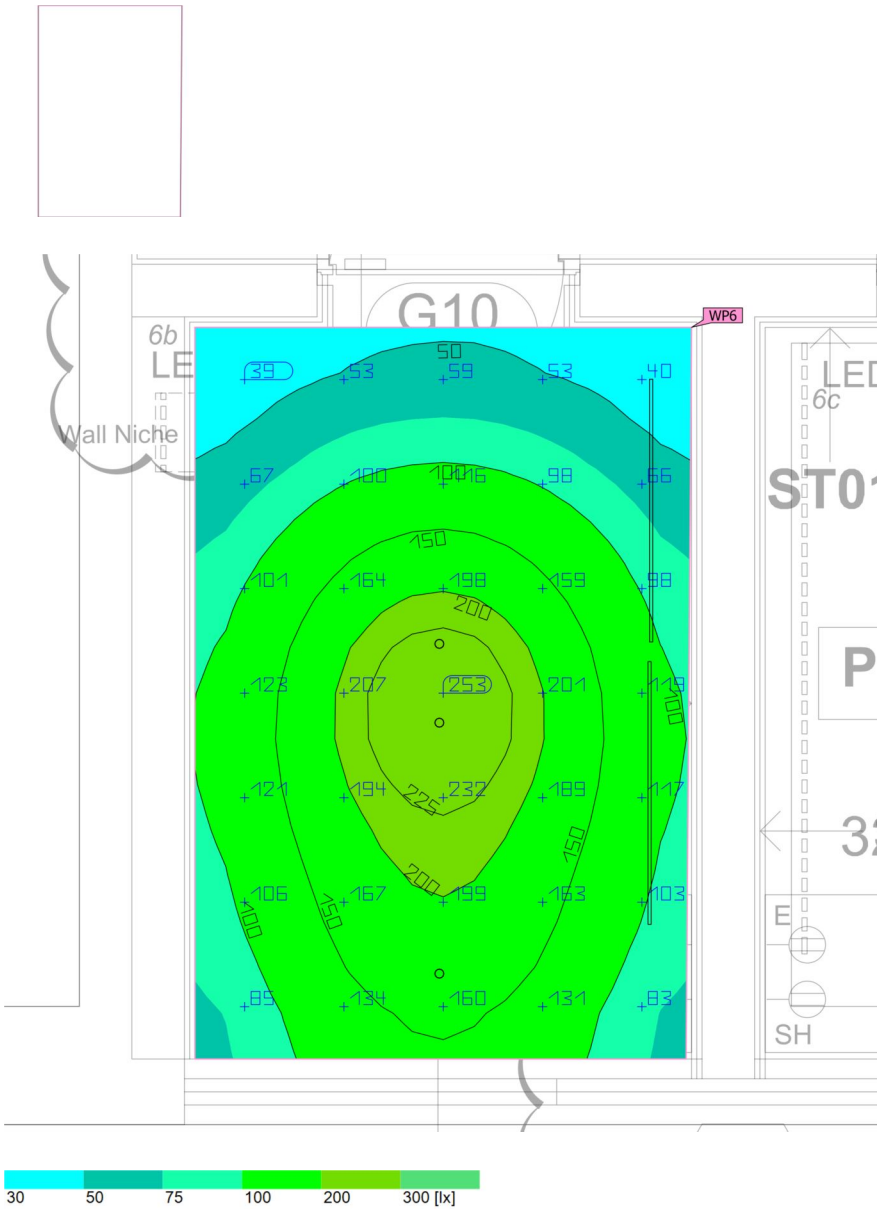

Properties	$\bar{E}$	$E_{min}$	$E_{max}$	$g_1$	$g_2$	Index
Working plane (Family Toilet 1) Perpendicular illuminance (adaptive) Height: 0.800 m, Wall zone: 0.000 m	128 lx	33.6 lx	250 lx	0.26	0.13	WP6

Utilization profile: DIALux presetting, Standard (office)

Building 1 · Story 1 · Family Toilet 2 (Light scene 1)

### Summary

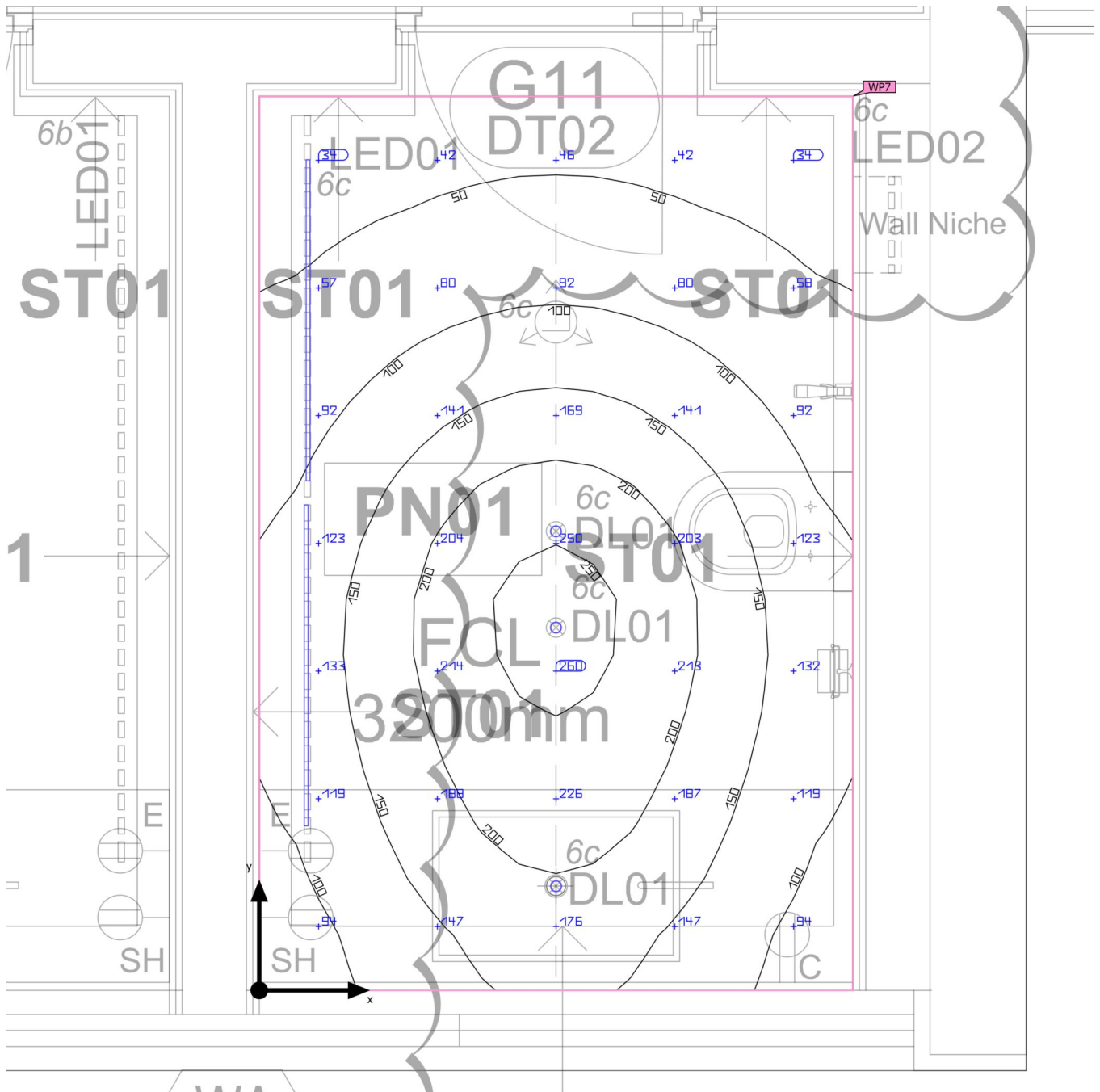

Building 1 · Story 1 · Family Toilet 2 (Light scene 1)

## Summary

### Results

	Symbol	Calculated	Index
Working plane	$\bar{E}_{\text{perpendicular}}$	130 lx	WP7
	$g_1$	0.23	WP7

Utilization profile: DIALux presetting, Standard (office)

### Luminaire list

pcs.	Manufacturer	Article No.	Article name	P	$\Phi$	Luminous efficacy
3	Linea Light Group	80640W30	Epitax Downlight 6W DC	6.0 W	351 lm	58.5 lm/W
2	Linea Light Group	98779	PU_C Plus - LED strip, IP66 - Led 12.6 W	12.6 W	1298 lm	103.0 lm/W

Building 1 · Story 1 · Family Toilet 2 (Light scene 1)

### Calculation objects

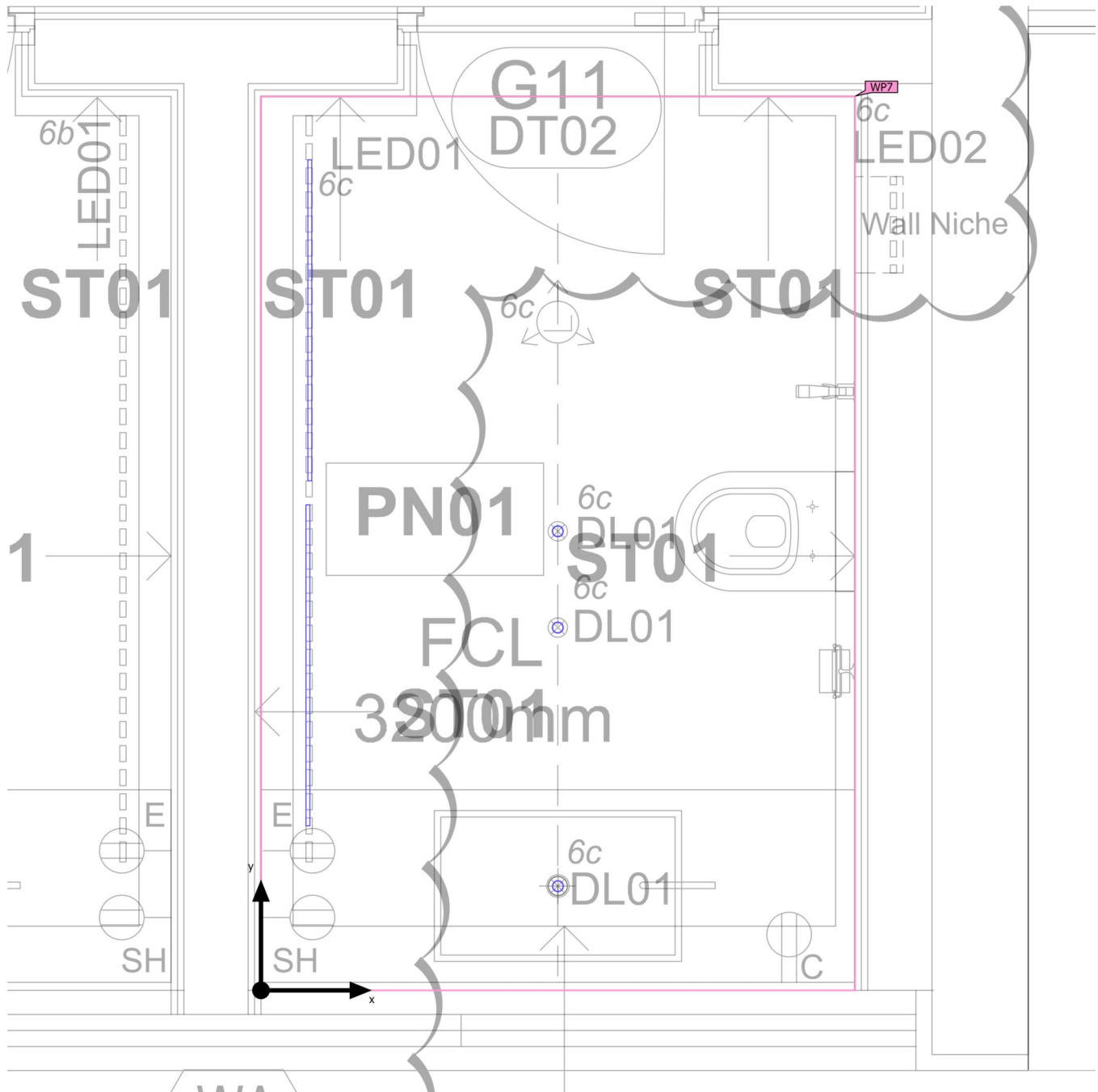

Building 1 · Story 1 · Family Toilet 2 (Light scene 1)

## Calculation objects

### Working planes

Properties	$\bar{E}$	$E_{min}$	$E_{max}$	$g_1$	$g_2$	Index
Working plane (Family Toilet 2) Perpendicular illuminance (adaptive) Height: 0.800 m, Wall zone: 0.000 m	130 lx	30.0 lx	262 lx	0.23	0.11	WP7

Utilization profile: DIALux presetting, Standard (office)



Building 1 · Story 1 · Family Toilet 2 (Light scene 1)  
**Working plane (Family Toilet 2)**

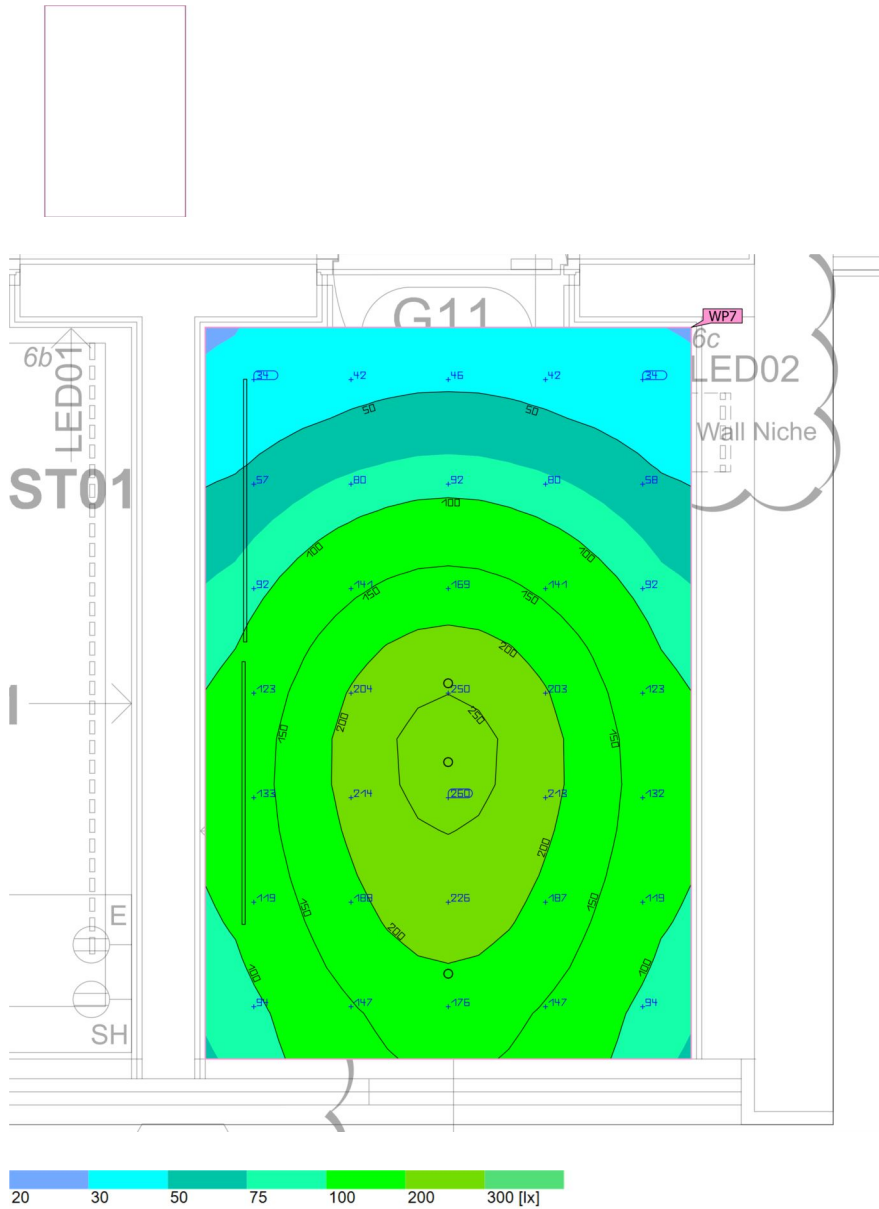

Properties	$\bar{E}$	$E_{min}$	$E_{max}$	$g_1$	$g_2$	Index
Working plane (Family Toilet 2) Perpendicular illuminance (adaptive) Height: 0.800 m, Wall zone: 0.000 m	130 lx	30.0 lx	262 lx	0.23	0.11	WP7

Utilization profile: DIALux presetting, Standard (office)

Building 1 · Story 1 · Guest Toilet 1 (Light scene 1)

### Summary

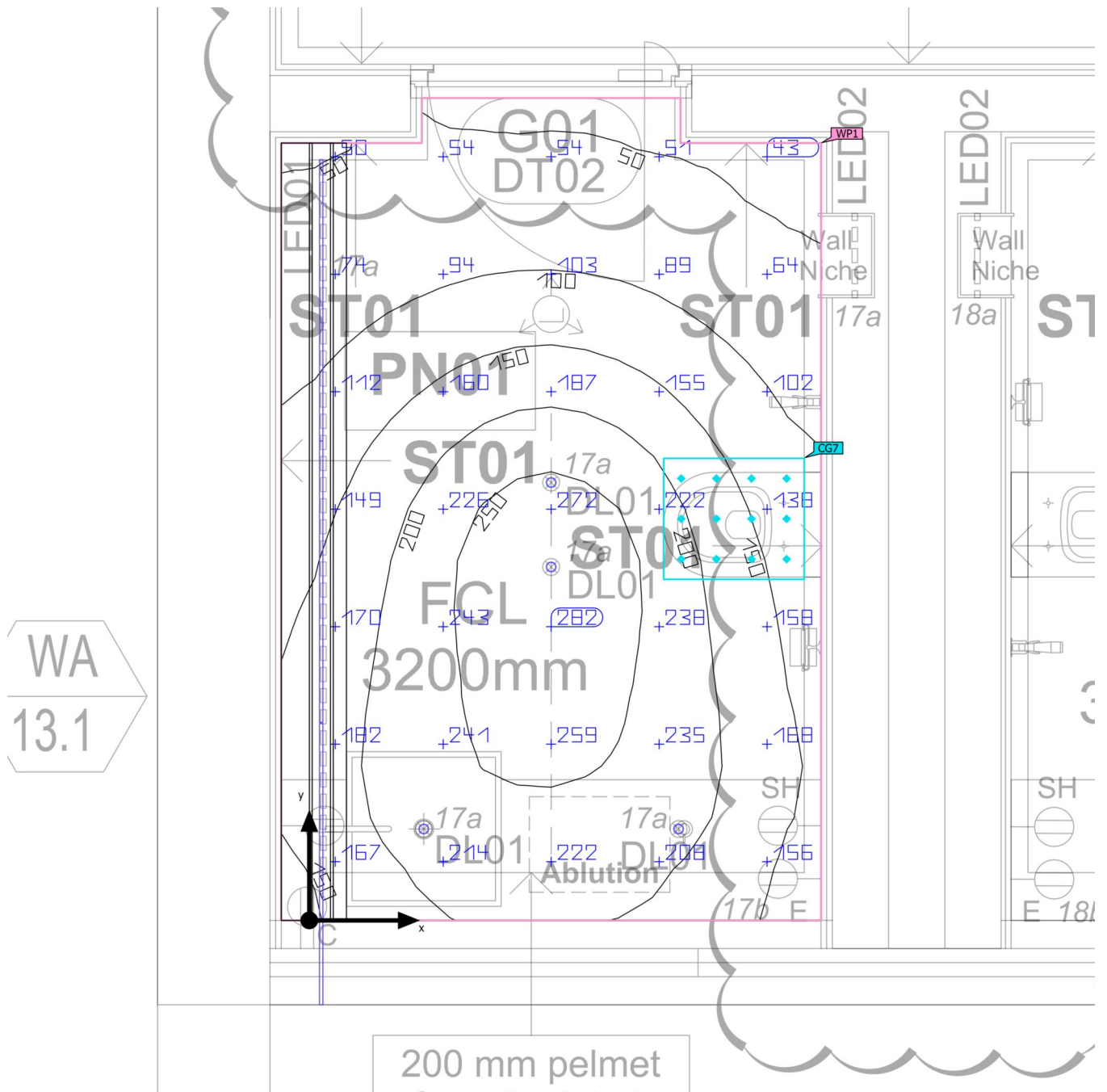

Building 1 · Story 1 · Guest Toilet 1 (Light scene 1)

## Summary

### Results

	Symbol	Calculated	Index
Working plane	$\bar{E}_{\text{perpendicular}}$	161 lx	WP1
	$g_1$	0.26	WP1

Utilization profile: DIALux presetting, Standard (office)

### Luminaire list

pcs.	Manufacturer	Article No.	Article name	P	$\Phi$	Luminous efficacy
4	Linea Light Group	80640W30	Epitax Downlight 6W DC	6.0 W	351 lm	58.5 lm/W
3	Linea Light Group	98779	PU_C Plus - LED strip, IP66 - Led 12.6 W	12.6 W	1298 lm	103.0 lm/W

Building 1 · Story 1 · Guest Toilet 1 (Light scene 1)

### Calculation objects

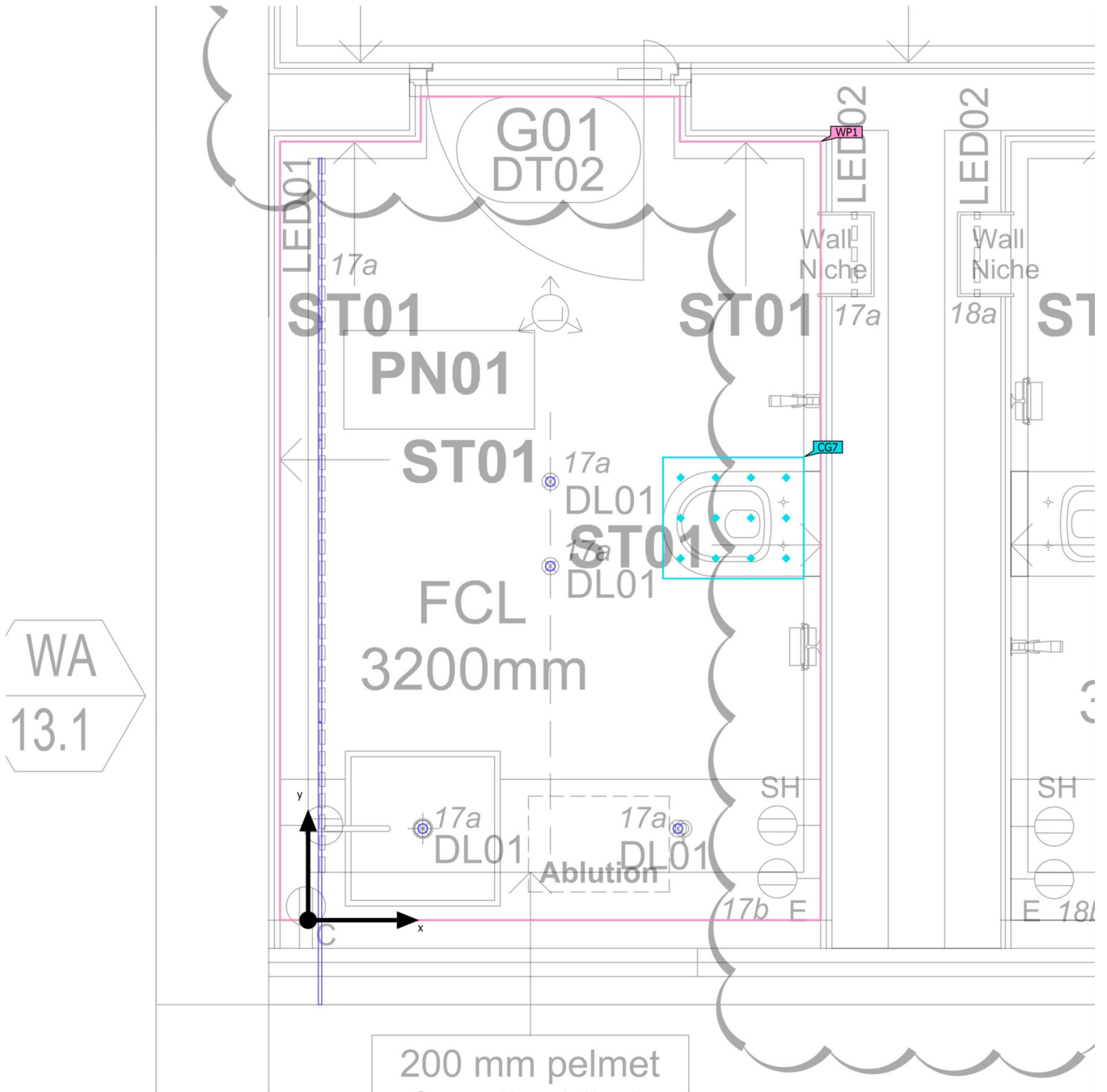

Building 1 · Story 1 · Guest Toilet 1 (Light scene 1)

## Calculation objects

### Working planes

Properties	$\bar{E}$	$E_{min}$	$E_{max}$	$g_1$	$g_2$	Index
Working plane (Guest Toilet 1) Perpendicular illuminance (adaptive) Height: 0.800 m, Wall zone: 0.000 m	161 lx	42.6 lx	283 lx	0.26	0.15	WP1

### Calculation surfaces

Properties	$\bar{E}$	$E_{min}$	$E_{max}$	$g_1$	$g_2$	Index
Calculation surface 7 Perpendicular illuminance Height: 0.000 m	141 lx	112 lx	169 lx	0.79	0.66	CG7

Utilization profile: DIALux presetting, Standard (office)

Building 1 · Story 1 · Guest Toilet 1 (Light scene 1)

### Working plane (Guest Toilet 1)

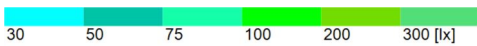
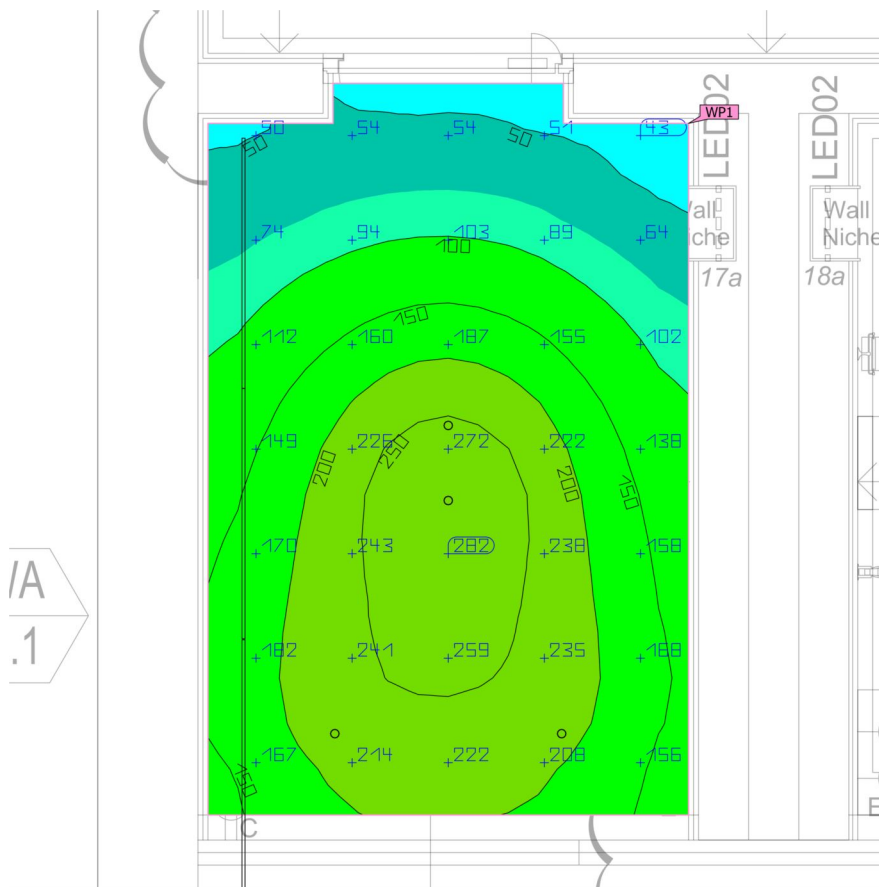
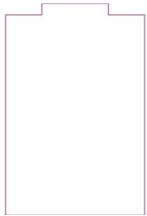

Properties	$\bar{E}$	$E_{min}$	$E_{max}$	$g_1$	$g_2$	Index
Working plane (Guest Toilet 1) Perpendicular illuminance (adaptive) Height: 0.800 m, Wall zone: 0.000 m	161 lx	42.6 lx	283 lx	0.26	0.15	WP1

Utilization profile: DIALux presetting, Standard (office)

Building 1 · Story 1 · Guest Toilet 1 (Light scene 1)

### Calculation surface 7

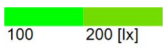
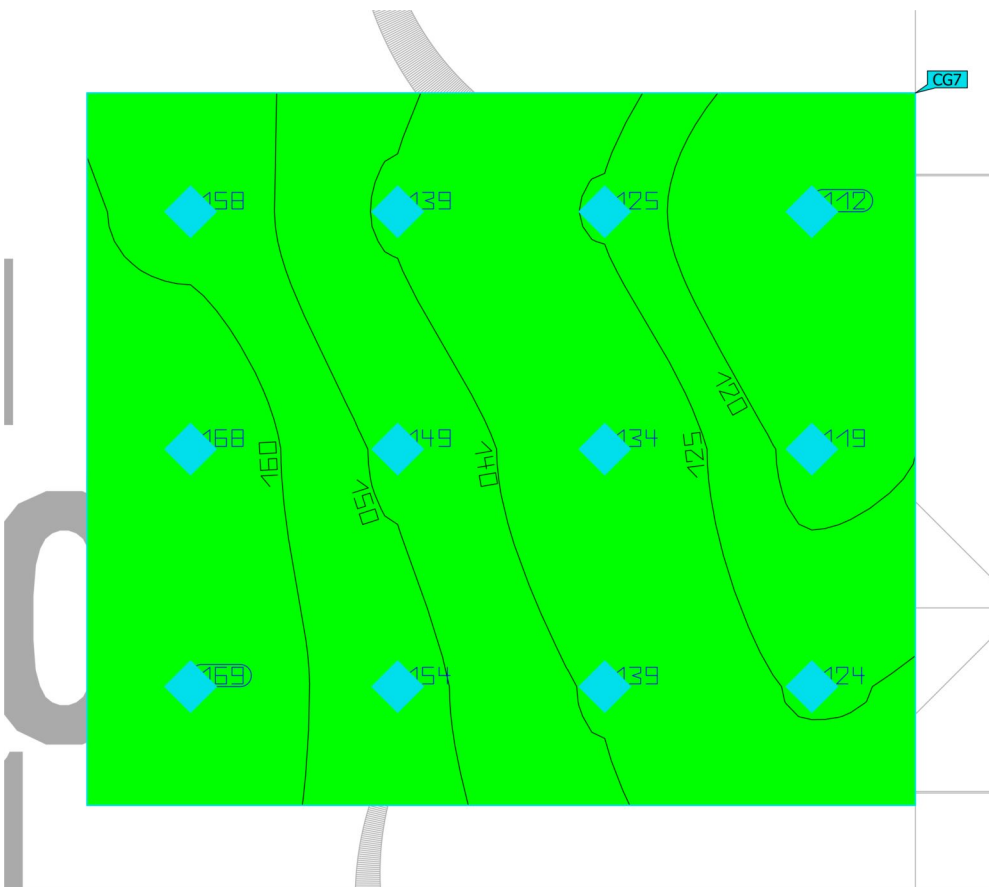
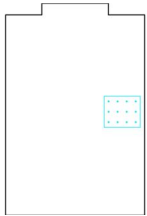

Properties	$\bar{E}$	$E_{min}$	$E_{max}$	$g_1$	$g_2$	Index
Calculation surface 7 Perpendicular illuminance Height: 0.000 m	141 lx	112 lx	169 lx	0.79	0.66	CG7

Utilization profile: DIALux presetting, Standard (office)